

WESTLEC Series Terminals

» *Always for your safety*

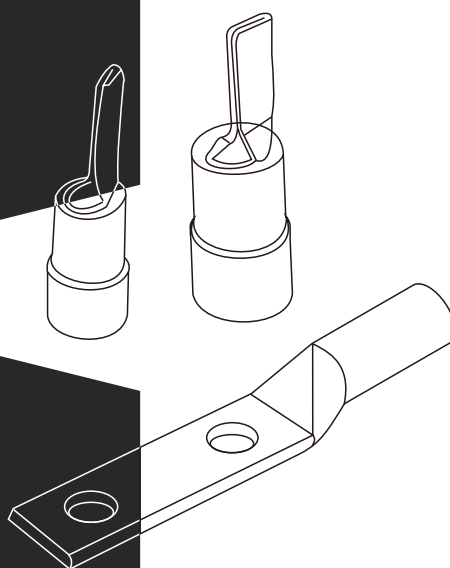

**WENZHOU ETEK
IMPORT & EXPORT CO.,LTD.**

COMPANY INTRODUCTION

WESTLEC is a professional exporter of low-voltage electrical products and accessories headquartered in Wenzhou, Zhejiang, China. We specialize in manufacturing and supplying terminal blocks, connectors, busbars, DIN rails and related components, which are widely applied in industrial automation, power distribution systems, electrical engineering and building electrical installations.

With a robust domestic supply chain network, we have established long-term partnerships with qualified manufacturers to ensure product consistency and reliability. Our products strictly comply with international standards including EN, IEC etc., while offering flexible customization options to meet specific project requirements. Backed by over 10 years of industry expertise, WESTLEC provides comprehensive solutions encompassing product selection, technical consultation, and efficient logistics support to global clients.

Looking ahead, WESTLEC remains committed to continuous product innovation and service enhancement. By integrating advanced technologies and sustainable practices, we aim to deliver smarter electrical connection solutions that drive efficiency and environmental responsibility across global markets. Our vision is to become a trusted partner for electrical professionals worldwide, contributing to safer and more intelligent power distribution systems.



Two Holes Long Barrel Copper Lugs	01
One Hole Long Barrel Copper Lugs	01
One Hole Offset Floating Tongue Lugs	02
List Of Parameters	03
Chana Electric Terminals&connectors	04
Special Pin Vinyl-Insulated terminal	05
Special Tubular Vinyl-Insulated terminal	05
Spade Vinyl-Insulated Terminal(TU-JTK)	06
Spade Nylon-Insulated Terminal(Copper Seleeve)	08
Spade Non-Insulated Terminal(TU)	09
Ring Vinyl-Insulated Terminal(TO-JTK)	10
Ring Vinyl-Insulated Terminal PVC	11
Ring Nylon-Insulated Terminal (Copper Seleeve)	12
Ring Non-Insulated Terminal(TO)	13
Copper Tube Terminal(DTGA&DTGY)	17
Insulated Cord End Terminal(TG-JT)	18
Non-Insulated Cord End Terminal(TG)	20
Insulated Twin Cord End Terminal	21
Screw On Wire Connector	21
Vinyl-Insulated Female Disconnections	22
Splice Connector	22
Vinyl-Insulated Bullet Disconnections	23
Nylon-Insulated Female Disconnections	24
Nylon-Insulated Bullet Disconnections	24
Vinyl-Insulated Male Disconnections	25
Nylon-Insulated Male Disconnections	25
Vinyl Fully Insulated Female Disconnections	26
Vinyl Fully Insulated Receptacle Disconnections	26
Vinyl -Insulated Piggy-Back Disconnections	27
Close-End Wire Connector	27
Vinyl -Insulated Blade Terminal	28
Nylon -Insulated Blade Terminal	28
Non-Insulated Blade Terminal	29
Vinyl-Insulated PIN Terminal	30
Nylon-Insulated PIN Terminal	30
Vinyl-Insulated Butt Splice Terminal(TL-JTK)	31
Non-Insulated Butt Splice Terminal	31
Locking Spade Vinyl-Insulated Terminal	32
Hook Ring Vinyl-Insulated Terminal	32
Locking Spade Non-Insulated Terminal	33
Hook Ring Non-Insulated Terminal	33
Flange Spade Vinyl-Insulated Terminal	34
Lipped Blade Vinyl-Insulated Terminal	34
Long Full Insulating Middle Joint(Nylon)	35
Flag Female Insulating Joint(Nylon)	35
Male and Female Full-Insulating Joint(Nylon)	36
PVC Insulated Terminal Sleeve	37
Open Barrel Terminals (Female&Male)	38
Terminals Blocks	39
Circle Cable Clips	40
Square Cable Clips	40
Double Nail Flat Cable Clips	40



Two Holes Long Barrel Copper Lugs

Two-Holes Lug Long Barrel

U.L.listed per 486A up to 35KV.
Ideal for industrial,oilrig,mining,welding & transportation termination application.heavy duty design which permits additional crimp for added mechanical strength.

ITEM NO.	Dimension(mm)				Color	A.W.G
	d	D	L	L1		
2L16M6	4.8	7.5	66	35	Blue	6
2L25M6	6	8.7	68	34	Gray	4
2L35M8	7.5	10.5	78.5	36	Brown	2
2L50M8	10	13	85	45	Pink	1/0
2L70M12	11	14.5	122.5	47	Black	2/0
2L95M12	13.5	17.5	129	53	Purple	4/0
2L120M12	15	19	131	55	Yellow	250KCMIL
2L150M12	18	22.5	144	67.5	Red	350KCMIL
2L185M12	19	24	153	76	Blue	400KCMIL
2L240M12	21	27	155	76	Brown	500KCMIL
2L300M12	22.5	29	172	90	Green	600KCMIL
2L400M12	26	33	168	92	Black	750KCMIL
2L500M12	30	38	160	98	White	1000KCMIL

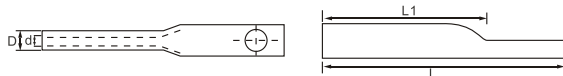

One Hole Long Barrel Copper Lugs

One-Hole Lug Long Barrel

U.L.listed per 486A up to 35KV.
Ideal for industrial,oil rig,mining,welding & transportation termination application.heavy duty design which permits additional crimp for added mechanical strength.

ITEM NO.	Dimension(mm)				Color	A.W.G
	d	D	L	L1		
L10M6	5.0	7	38.7	22	RED	8
L16M6	4.8	7.5	53.5	36.5	Blue	6
L25M6	6	8.7	52.5	35	Gray	4
L35M8	7.5	10.5	52.5	33	Brown	2
L50M8	10	13	62	42.5	Pink	1/0
L70M10	11	14.5	69.5	47.5	Black	2/0
L95M12	13.5	17.5	85	53	Purple	4/0
L120M12	15	19	85	55	Yellow	250KCMIL
L150M12	18.5	22	94.5	67	Red	350KCMIL
L185M16	19	24	154	75.5	Blue	400KCMIL
L240M16	21	27	116	78	Brown	500KCMIL
L300M16	22.5	29	125	91.8	Green	600KCMIL
L400M16	26	33	135	95	Black	750KCMIL
L500M16	30	38	143	102	White	1000KCMIL

One Hole Offset Floating Tongue Lugs

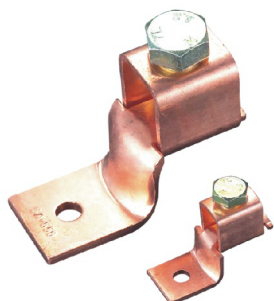

High copper alloy terminal with offset tongue for joining a wide range of cable to equipment pads or bar. easy to install with screwdriver or wrench. connector is re-usable. plain copper finish.

Features	Benefits
Convenient range-taking design.	Reduces catalog number. One connector accommodates several conductor sizes.
High conductivity copper alloy.	Long lasting reliable contact.
Compact design.	Easy to use, Reduces labor time.
Slot Robertson screw, hex head/hex socket bolt.	No special installation tools required. Eliminates over-torquing/potential conductor damage.

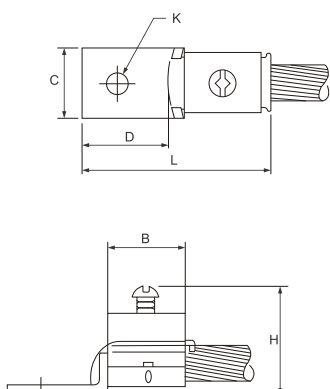

Fig. 1

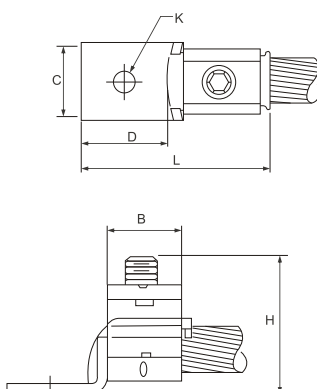

Fig. 2

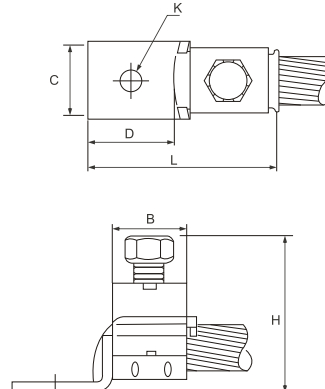
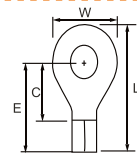

Fig. 3

All sizes are inch

Catalog Number	FIG	Wire Range	Dimension(mm)					Stud hole size	L	Screw type	Screw size	Recommendes tightening torque
			B	C	D	H	K					
KLU25	1	14-10	0.28	0.31	0.47	0.66	0.14	8	0.91	Slot Robertson	8/32	20
KLU35	1	14-6	0.43	0.38	0.57	0.91	0.20	10	1.71	Slot Robertson	1/4	45
KLU70	1	8-2	0.50	0.50	0.61	1.05	0.27	1/4	1.32	Slot Robertson	5/16	50
KLU125	1	2-1/0	0.61	0.62	0.86	1.50	0.26	1/4	1.78	Slot Robertson	3/8	50
KLU175	2	4-3/0	0.75	0.75	1.20	1.40	0.41	3/8	2.20	Hex Socket	3/8	124
KLU225	2	2-4/0	1.00	1.00	1.24	1.64	0.34	5/16	2.54	Hex Socket	7/16	204
KLU300	3	1/0-350	1.21	1.10	1.60	2.63	0.41	3/8	3.25	Hex Head	5/8	325
KLU400	3	1/0-500	1.49	1.50	2.12	2.74	0.41	3/8	4.26	Hex Head	5/8	375
KLU650	3	600-1000	1.88	2.00	1.90	3.73	0.53	1/2	4.61	Hex Head	3/4	500

List Of Parameters



ITEM NO.	Wire Range (AWG)	Stud Size	L(Inch)	Thickness	Barrel Length	Barrel I.D.
917535	26-22	#6	0.591	0.02	0.25	0.045
917504	26-22	#8	0.681	0.02	0.25	0.045
917505	26-22	#10	0.724	0.02	0.25	0.045
917506	26-22	1/4	0.854	0.02	0.25	0.045
911035	22-18	#6	0.685	0.03	0.25	0.07
911004	22-18	#8	0.728	0.03	0.25	0.07
911005	22-18	#10	0.732	0.03	0.25	0.07
911005L	22-18	#10	0.701	0.03	0.25	0.07
911006	22-18	1/4	0.917	0.03	0.25	0.07
912035	16-14	#6	0.795	0.03	0.25	0.09
912004	16-14	#8	0.795	0.03	0.25	0.09
912005	16-14	#10	0.709	0.03	0.25	0.09
912005L	16-14	#10	0.787	0.03	0.25	0.09
912006	16-14	1/4	0.917	0.03	0.25	0.09

ITEM NO.	Wire Range (AWG)	Stud Size	L(Inch)	Thickness	Barrel Length	Barrel I.D.
912006L	16-14	1/4	0.917	0.03	0.25	0.09
912008	16-14	5/16	0.921	0.03	0.25	0.09
912008L	16-14	5/16	0.923	0.03	0.25	0.07
912010	16-14	3/8	0.949	0.03	0.25	0.09
915004	12-10	#8	0.900	0.04	0.25	0.135
915005	12-10	#10	0.709	0.04	0.25	0.135
915005L	12-10	#10	0.906	0.04	0.26	0.135
915006	12-10	1/4	0.937	0.04	0.25	0.135
915006L	12-10	1/4	0.957	0.04	0.25	0.135
915006L	12-10	1/4	0.996	0.04	0.26	0.135
915008	12-10	5/16	1.004	0.04	0.26	0.135
915010	12-10	3/8	1.047	0.04	0.26	0.135
915012	12-10	1/2	1.114	0.04	0.26	0.135

List Of Parameters

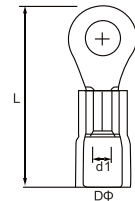

NYLON+ COPPER SLEEVE		Wire Range (AWG)	Stud Size	L(Inch)	D	Thickness	Barrel Length
921035	931035	22-18	#6	0.925	0.03	0.25	0.07
921035L	931035L	22-18	#6	0.965	0.03	0.25	0.07
921004	931004	22-18	#8	0.969	0.03	0.25	0.07
921005	931005	22-18	#10	0.972	0.03	0.25	0.07
921005L	931005L	22-18	#10	0.945	0.03	0.25	0.07
921006	931006	22-18	1/4	1.173	0.03	0.25	0.07
922035	932035	16-14	#6	0.846	0.03	0.25	0.09
922004	932004	16-14	#8	0.846	0.03	0.25	0.09
922005	932005	16-14	#10	0.965	0.03	0.25	0.09
922005L	932005L	16-14	#10	1.031	0.03	0.25	0.09
922006	932006	16-14	1/4	1.157	0.03	0.25	0.09
922006L	932006L	16-14	1/4	1.169	0.03	0.25	0.09
922008	932008	16-14	5/16	1.076	0.03	0.25	0.09
922008L	932008L	16-14	5/16	1.169	0.03	0.25	0.09

NYLON+ COPPER SLEEVE		Wire Range (AWG)	Stud Size	L(Inch)	D	Thickness	Barrel Length
922010	932010	16-14	3/8	1.193	0.03	0.25	0.09
922010L	932010L	16-14	3/8	1.165	0.03	0.25	0.09
925004	935004	12-10	#8	0.937	0.04	0.25	0.135
925005	935005	12-10	#10	1.024	0.04	0.25	0.135
925005M	935005M	12-10	#10	1.201	0.04	0.26	0.135
925005L	935005L	12-10	#10	1.264	0.04	0.26	0.135
925006	935006	12-10	1/4	1.252	0.04	0.25	0.135
925006M	935006M	12-10	1/4	1.291	0.04	0.26	0.135
925006L	935006L	12-10	1/4	1.272	0.04	0.26	0.135
925008	935008	12-10	5/16	1.299	0.04	0.26	0.135
925008L	935008L	12-10	5/16	1.272	0.04	0.26	0.135
925010	935010	12-10	3/8	1.343	0.04	0.26	0.135
925012	935012	12-10	1/2	1.409	0.04	0.26	0.135

AWG(American Wire Gauge) terminal and connector suit for American market and area that use such standard,for example:USA, CANADA,MEXICO,COLOMBIA,BRAZIL,KINGDOM OF SAUDI,PHILIPPINES etc.



WESTLEC Electric Terminals&connectors





Special Pin Vinyl-Insulated terminal

Manufactured in copper with tin coating by galvanic electroplating process.
Dimensions Listed In Table Are Aproximate

TPP-10 8AWG 10mm ²	TPP-16 6AWG 16mm ²	TPP-25 4AWG 25mm ²	TPP-35 2AWG 35mm ²



Special Tubular Vinyl-Insulated terminal

Manufactured in copper with tin Can be used with ATP-49 or similar type pliers.
Dimensions Listed In Table Are Aproximate

ITEM NO.	Φ HOLE (mm)	Conductor size	
		A.W.G	mm ²
TPT-10	4-5-6-8	8	10.0
TPT-16	5-6-8	6	16.0
TPT-25	5-6-8-10	4	25.0
TPT-35	6-8-10-12	2	35.0
TPT-50	6-8-10-11-12	1/0	50.0
TPT-70	6-8-10-11-12	2/0	70.0

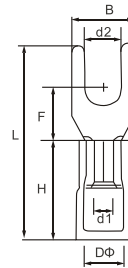

SV NSV

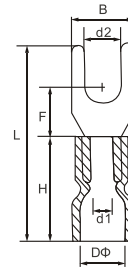

ESV
(easy entry)

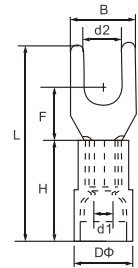

C-SV NC-SV
(copper sleeve)

Spade Vinyl-Insulated Terminal(TU-JTK)

ITEM NO.	USA SCREW	Screw dia. d2Φ(mm)	Dimension(mm)						Color	Explanation
			B	L	F	H	DΦ	T		
SV 1.25-3	#4	3.2	6.5	21.6	5.7	10	4.3	0.7	Red	Cable size: 0.5-1.5mm ² Max current: I _{max} =19A Material: PVC+Copper Plating: Tin
SVS 1.25-3.5	#6	3.7	6.5	21.6	5.7					
SVL 1.25-3.5	#6	3.7	6.5	21.2	6.4					
SVS 1.25-4	#8	4.3	6.5	21.2	8.0					
SVM 1.25-4	#8	4.3	6.5	21.2	7.2					
SVL 1.25-4	#8	4.3	6.5	21.2	8.1					
SVS 1.25-5	#10	5.3	6.5	21.2	8.1					
SVL 1.25-5	#10	5.3	6.5	21.2	9.5					
SVS 1.25-6	1/4	6.4	6.5	21.2	9.5	10.6	4.9	0.8	Blue	Cable size: 1.5-2.5mm ² Max current: I _{max} =27A Material: PVC+Copper Plating: Tin
SVL 1.25-6	1/4	6.4	11.0	27.2	12.0					
SV 2-3	#4	3.2	5.7	21.6	6.5					
SVS 2-3.5	#6	3.7	5.7	21.2	6.5					
SVL 2-3.5	#6	3.7	6.0	21.2	6.5					
SVS 2-4	#8	4.3	6.4	21.2	6.5					
SVM 2-4	#8	4.3	7.2	21.2	6.5					
SVL 2-4	#8	4.3	8.1	21.2	6.5					
SVS 2-5	#10	5.3	8.1	21.2	6.5	13.0	6.2	1.0	Black	Cable size: 2.5-4mm ² A.W.G: 14-12 Max current: I _{max} =37A Material: PVC+Copper Plating: Tin
SVL 2-5	#10	5.3	9.5	21.2	6.5					
SVS 2-6	1/4	6.4	9.5	21.2	6.5					
SVL 2-6	1/4	6.4	12.0	27.8	11.0					
SV3.5-3	#4	3.2	5.7	26.8	7.0					
SV3.5-4	#8	4.3	8.0	24.8	7.0					
SV3.5-5	#10	5.3	8.0	24.8	7.0					
SV3.5-6	1/4	6.4	12.1	28.3	12.1					
SV 5.5-3.5	#6	3.7	8.4	26	7.5	13.0	6.7	1.0	Yellow	Cable size: 4-6mm ² Max current: I _{max} =48A Material: PVC+Copper Plating: Tin
SVS 5.5-4	#8	4.3	8.4	26	7.5					
SVL 5.5-4	#8	4.3	9.0	26	7.5					
SV 5.5-5	#10	5.3	9.0	26	7.5					
SVS 5.5-6	1/4	6.4	9.0	26	7.5					
SVL 5.5-6	1/4	6.4	12.0	32	12.0					
SV 5.5-8	5/16	8.4	14.0	31	11.5					

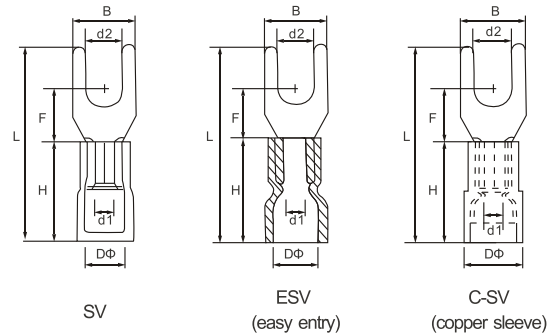

Spade Vinyl-Insulated Terminal(TU-JTK)

Easy Entry And Copper Sleeve

ITEM NO.		USA SCREW	Screw dia. d2Φ(mm)	Dimension(mm)						Color	Explanation
				B	L	F	H	DΦ	T		
ESV 1.25-3	C-SV 1.25-3	#4	5.7	6.5	21.6	5.7	10.0	4.3	0.7	Red	Cable size: 0.5-1.5mm ² Max current: I _{max} =19A Material: PVC+Copper Plating: Tin
ESVS 1.25-3.5	C-SVS 1.25-3.5	#6	5.7	6.5	21.6	5.7					
ESVL 1.25-3.5	C-SVL 1.25-3.5	#6	6.4	6.5	21.2	6.4					
ESVS 1.25-4	C-SVS 1.25-4	#8	8.0	6.5	21.2	8.0					
ESVM 1.25-4	C-SVM 1.25-4	#8	7.2	6.5	21.2	7.2					
ESVL 1.25-4	C-SVL 1.25-4	#8	8.1	6.5	21.2	8.1					
ESVS 1.25-5	C-SVS 1.25-5	#10	8.1	6.5	21.2	8.1					
ESVL 1.25-5	C-SVL 1.25-5	#10	9.5	6.5	21.2	9.5					
ESVS 1.25-6	C-SVS 1.25-6	1/4	9.5	6.5	21.2	9.5					
ESVL 1.25-6	C-SVL 1.25-6	1/4	12.0	11.0	27.2	12.0	10.6	4.9	0.8	Blue	Cable size: 1.5-2.5mm ² Max current: I _{max} =27A Material: PVC+Copper Plating: Tin
ESV 2-3	C-SV 2-3	#4	3.2	5.7	21.6	6.5					
ESVS 2-3.5	C-SVS 2-3.5	#6	3.7	5.7	21.2	6.5					
ESVL 2-3.5	C-SVL 2-3.5	#6	3.7	6.0	21.2	6.5					
ESVS 2-4	C-SVS 2-4	#8	4.3	6.4	21.2	6.5					
ESVM 2-4	C-SVM 2-4	#8	4.3	7.2	21.2	6.5					
ESVL 2-4	C-SVL 2-4	#8	4.3	8.1	21.2	6.5					
ESVS 2-5	C-SVS 2-5	#10	5.3	8.1	21.2	6.5					
ESVL 2-5	C-SVL 2-5	#10	5.3	9.5	21.2	6.5					
ESVS 2-6	C-SVS 2-6	1/4	6.4	9.5	21.2	6.5					
ESVL 2-6	C-SVL 2-6	1/4	6.4	12.0	27.8	11.0	13.0	6.2	1.0	Black	Cable size: 2.5-4mm ² A.W.G: 14-12 Max current: I _{max} =37A Material: PVC+Copper Plating: Tin
ESV3.5-3	C-SV3.5-3	#4	3.2	5.7	26.8	7.0					
ESV3.5-4	C-SV3.5-4	#8	4.3	8.0	24.8	7.0					
ESV3.5-5	C-SV3.5-5	#10	5.3	8.0	24.8	7.0					
ESV3.5-6	C-SV3.5-6	1/4	6.4	12.1	28.3	12.1	13.0	6.7	1.0	Yellow	Cable size: 4-6mm ² Max current: I _{max} =48A Material: PVC+Copper Plating: Tin
ESV 5.5-3.5	C-SV 5.5-3.5	#6	3.7	8.4	26	7.5					
ESVS 5.5-4	C-SVS 5.5-4	#8	4.3	8.4	26	7.5					
ESVL 5.5-4	C-SVL 5.5-4	#8	4.3	9.0	26	7.5					
ESV 5.5-5	C-SV 5.5-5	#10	5.3	9.0	26	7.5					
ESVS 5.5-6	C-SVS 5.5-6	1/4	6.4	9.0	26	7.5					
ESVL 5.5-6	C-SVL 5.5-6	1/4	6.4	12.0	32	12.0					
ESV 5.5-8	C-SV 5.5-8	5/16	8.4	14.0	31	11.5					

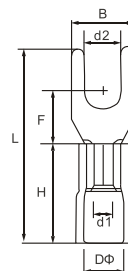

NSV
(Nylon)

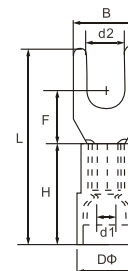

NC-SV
(Nylon+copper sleeve)

Spade Nylon -Insulated Terminal(Copper Seleeve)

Spade NYLON-Insulated Terminal

ITEM NO.		USA SCREW	Screw dia. d2Φ(mm)	Dimension(mm)					Color	Explanation
				B	L	F	H	DΦ		
NSV 1.25-3	NC-SV 1.25-3	#4	5.7	6.5	21.6	5.7	10.0	4.3	Red	Cable size: 0.5-1.5mm ² (A.W.G22~16) Max current: I _{max} =19A Material: Nylon & Copper Thickness: 0.7mm Plating: Tin
NSVS 1.25-3.5	NC-SVS 1.25-3.5	#6	5.7	6.5	21.6	5.7				
NSVL 1.25-3.5	NC-SVL 1.25-3.5	#6	6.4	6.5	21.2	6.4				
NSVS 1.25-4	NC-SVS 1.25-4	#8	8.0	6.5	21.2	8.0				
NSVM 1.25-4	NC-SVM 1.25-4	#8	7.2	6.5	21.2	7.2				
NSVL 1.25-4	NC-SVL 1.25-4	#8	8.1	6.5	21.2	8.1				
NSVS 1.25-5	NC-SVS 1.25-5	#10	8.1	6.5	21.2	8.1				
NSVL 1.25-5	NC-SVL 1.25-5	#10	9.5	6.5	21.2	9.5				
NSVS 1.25-6	NC-SVS 1.25-6	1/4	9.5	6.5	21.2	9.5	10.6	4.9	Blue	Cable size: 1.5-2.5mm ² (A.W.G16-14) Max current: I _{max} =27A Material: Nylon & Copper Thickness: 0.8mm Plating: Tin
NSVL 1.25-6	NC-SVL 1.25-6	1/4	12.0	11.0	27.2	12.0				
NSV 2-3	NC-SV 2-3	#4	3.2	5.7	21.6	6.5				
NSVS 2-3.5	NC-SVS 2-3.5	#6	3.7	5.7	21.2	6.5				
NSVL 2-3.5	NC-SVL 2-3.5	#6	3.7	6.0	21.2	6.5				
NSVS 2-4	NC-SVS 2-4	#8	4.3	6.4	21.2	6.5				
NSVM 2-4	NC-SVM 2-4	#8	4.3	7.2	21.2	6.5				
NSVL 2-4	NC-SVL 2-4	#8	4.3	8.1	21.2	6.5				
NSVS 2-5	NC-SVS 2-5	#10	5.3	8.1	21.2	6.5	13.0	6.7	Yellow	Cable size: 4-6mm ² (A.W.G12~10) Max current: I _{max} =48A Material: Nylon & Copper Thickness: 1.0mm Plating: Tin
NSVL 2-5	NC-SVL 2-5	#10	5.3	9.5	21.2	6.5				
NSVS 2-6	NC-SVS 2-6	1/4	6.4	9.5	21.2	6.5				
NSVL 2-6	NC-SVL 2-6	1/4	6.4	12.0	27.8	11.0				
NSV 5.5-3.5	NC-SV 5.5-3.5	#6	3.7	8.4	26	7.5				
NSVS 5.5-4	NC-SVS 5.5-4	#8	4.3	8.4	26	7.5				
NSVL 5.5-4	NC-SVL 5.5-4	#8	4.3	9.0	26	7.5				
NSV 5.5-5	NC-SV 5.5-5	#10	5.3	9.0	26	7.5				
NSVS 5.5-6	NC-SVS 5.5-6	1/4	6.4	9.0	26	7.5				
NSVL 5.5-6	NC-SVL 5.5-6	1/4	6.4	12.0	32	12.0				
NSV 5.5-8	NC-SV 5.5-8	5/16	8.4	14.0	31	11.5				

Spade Non-Insulated Terminal(TU)

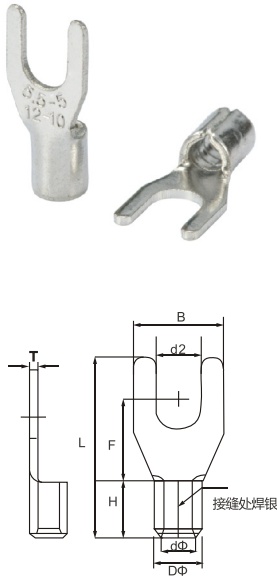

ITEM NO.	USA SCREW	d2Φ (mm)	Dimension(mm)						Explanation
			B	L	F	E	DΦ	dΦ	
SNB1.25-3	#4	3.2	5.7	16.0	6.5	4.8	3.4	1.7	Cable size: 0.5-1.5mm² (A.W.G22~16) Max current: I _{max} =27A Material: Copper Thickness: 0.7mm Plating: Tin
SNBS1.25-3.5	#6	3.7	5.7	16.0	6.5				
SNBL1.25-3.5	#6	3.7	6.4	15.5	6.5				
SNBS1.25-4	#8	4.3	6.4	15.5	6.5				
SNBM1.25-4	#8	4.3	7.2	15.5	6.5				
SNBL1.25-4	#8	4.3	8.1	15.5	6.5				
SNBS1.25-5	#10	5.3	8.1	15.5	6.5				
SNBL1.25-5	#10	5.3	9.5	15.5	6.5				
SNBS1.25-6	1/4	6.4	9.5	15.5	6.5				
SNBL1.25-6	1/4	6.4	12.0	22.0	11.0				
SNB 2-3	#4	3.2	5.7	16.0	6.5	4.8	4.1	2.3	Cable size: 1.5-2.5mm² (A.W.G16~14) Max current: I _{max} =27A Material: Copper Thickness: 0.8mm Plating: Tin
SNBS 2-3.5	#6	3.7	5.7	16.0	6.5				
SNBL 2-3.5	#6	3.7	6.0	16.0	6.5				
SNBS 2-4	#8	4.3	6.4	16.0	6.5				
SNBM 2-4	#8	4.3	7.2	16.0	6.5				
SNBL 2-4	#8	4.3	8.1	16.0	6.5				
SNBS 2-5	#10	5.3	8.1	16.0	6.5				
SNBL 2-5	#10	5.3	9.5	16.0	6.5				
SNBS 2-6	1/4	6.4	9.5	16.0	6.5				
SNBL 2-6	1/4	6.4	12.0	22.0	11.0				
SNB 3.5-3	#4	3.2	5.7	18.3	7.0	6.0	5.0	3.0	Cable size: 2.5-4mm²(A.W.G14~12) Max current: I _{max} =37A Material: Copper Thickness: 1.0mm Plating: Tin
SNB 3.5-4	#8	4.3	8.0	18.3	7.0				
SNB 3.5-5	#10	5.3	8.0	18.3	7.0				
SNB 3.5-6	1/4	6.4	12.0	21.5	10.5				
SNB 5.5-3.5	#6	3.7	8.3	19.5	7.2	6.8	5.6	3.4	Cable size: 4-6mm² (A.W.G12~10) Max current: I _{max} =48A Material: Copper Thickness: 1.0mm Plating: Tin
SNBS 5.5-4	#8	4.3	8.3	19.5	7.2				
SNBL 5.5-4	#8	4.3	9.0	19.5	7.5				
SNB 5.5-5	#10	5.3	9.0	19.5	7.5				
SNBS 5.5-6	1/4	6.4	9.0	19.5	7.2				
SNBL 5.5-6	1/4	6.4	12.0	25.5	12.0				
SNB 5.5-8	5/16	8.4	14.0	24.5	11.5				
SNB 8-4	#8	4.3	8.7	23.0	6.0	8.5	7.2	4.5	Cable size: 6-10mm² (A.W.G6) Max current: I _{max} =88A Material: Copper Plating: Tin
SNB 8-5	#10	5.3	12.0	24.5	5.7	8.5	7.2	4.5	
SNB 8-6	1/4	6.4	12.0	24.5	5.7	8.5	7.2	4.5	
SNB 8-8	5/16	8.4	14.5	28.0	8.3	8.5	7.2	4.5	
SNB 14-6	1/4	6.4	12.0	28.0	7.5	10.5	9.0	5.8	
SNB 14-8	5/16	8.4	14.0	28.0	7.5	10.5	9.0	5.8	
SNB 22-8	5/16	8.4	14.0	34.5	9.0	12.0	11.5	7.7	

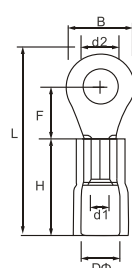

RV NRV

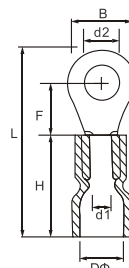

ERV
(easy entry)

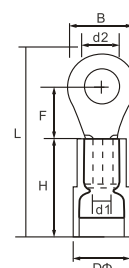

C-RV NC-RV
(copper sleeve)

Ring Vinyl-Insulated Terminal(TO-JTK)

ITEM NO.	USA SCREW	Screw dia. d2Φ(mm)	Dimension(mm)					Color	Explanation
			B	L	F	H	DΦ		
RV1.25-3	#4	3.2	5.7	18.7	4.95	10.6	4.3	Red	Cable size: 0.5-1.5mm ² (A.W.G22~16) Max current: I _{max} =19A Material: PVC+Copper Plating: Tin
RVS1.25-3.5	#6	3.7	5.7	18.7	4.95				
RVM1.25-3.5	#6	3.7	6.6	19.4	6.3				
RVL1.25-3.5	#6	3.7	8.0	21.2	7.0				
RVS1.25-4	#8	4.3	6.6	19.4	6.3				
RVL1.25-4	#8	4.3	8.0	21.2	7.0				
RVS1.25-5	#10	5.3	8.0	21.2	7.0				
RVL1.25-5	#10	5.3	9.8	23	8.5				
RVS1.25-6	1/4	6.4	9.8	23	8.5				
RVL1.25-6	1/4	6.4	11.6	26.8	11.1				
RV1.25-8	5/16	8.4	11.6	27.4	11.1				
RV1.25-10	3/8	10.5	13.6	27.4	13.9				
RV1.25-12	1/2	13.0	19.2	37.3	16.5	10.6	4.9	Blue	Cable size: 1.5-2.5mm ² (A.W.G16~14) Max current: I _{max} =27A Material: PVC+Copper Plating: Tin
RV 2-3	#4	3.2	6.6	17.5	4.3				
RVS 2-3.5	#6	3.7	6.6	17.5	4.3				
RVM 2-3.5	#8	3.7	6.6	20	6.2				
RVL 2-3.5	#6	3.7	8.5	22.8	7.75				
RVS 2-4	#8	4.3	6.6	20	6.2				
RVL 2-4	#8	4.3	8.5	22.8	7.75				
RVS 2-5	#10	5.3	8.5	22	7.75				
RVL 2-5	#10	5.3	9.5	22.6	7.25				
RVS 2-6	1/4	6.4	11.9	27.2	11.0				
RV 2-8	5/16	8.4	11.9	27.2	11.0				
RV 2-10	3/8	10.5	13.6	31.1	13.9				
RV 2-12	1/2	13.0	19.2	36.8	16.5	13.5	6.2	Black	Cable size: 2.5-4mm ² (A.W.G14-12) Max current: I _{max} =37A Material: PVC+Copper Plating:Tin
RV 3.5-4	#8	4.3	8.0	24.5	7.7				
RVS 3.5-5	#10	5.3	8.0	24.5	7.7				
RVL 3.5-5	#10	5.3	12.0	29	7.7				
RV 3.5-6	1/4	6.4	12.0	29	7.7	13.5	6.7	Yellow	Cable size: 4-6mm ² (A.W.G12~10) Max current: I _{max} =48A Material: PVC+Copper Plating:Tin
RV 5.5-3.5	#6	3.7	7.2	22	5.3				
RVS 5.5-4	#8	4.3	7.2	22	5.3				
RVL 5.5-4	#8	4.3	9.5	26.2	8.25				
RV 5.5-5	#10	5.3	9.5	26.2	8.25				
RVS 5.5-6	1/4	6.4	12.0	32.1	10.7				
RVL 5.5-6	1/4	6.4	12.0	32.8	13				
RV 5.5-8	5/16	8.4	15.0	34	13.7				
RV 5.5-10	3/8	10.5	15.0	34	13.7				
RV 5.5-12	1/2	13.0	19.2	38.8	16				

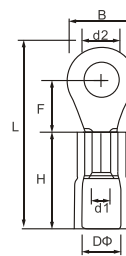

RV

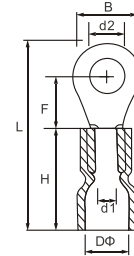

ERV
(easy entry)

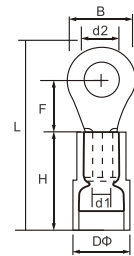

C-RV
(copper sleeve)

Ring Vinyl-Insulated Terminal PVC

Easy Entry and Copper Sleeve

ITEM NO.		USA SCREW	Screw dia. d2Φ(mm)	Dimension(mm)					Color	Explanation
				B	L	F	H	DΦ		
ERV1.25-3	C-RV1.25-3	#4	3.2	5.7	18.7	4.95	10.6	4.3	Red	Cable size: 0.5-1.5mm ² (A.W.G22~16) Max current I _{max} =19A Material: PVC+Copper Plating: Tin
ERVS1.25-3.5	C-RVS1.25-3.5	#6	3.7	5.7	18.7	4.95				
ERVM1.25-3.5	C-RVM1.25-3.5	#6	3.7	6.6	19.4	6.3				
ERVL1.25-3.5	C-RVL1.25-3.5	#6	3.7	8.0	21.2	7.0				
ERVS1.25-4	C-RVS1.25-4	#8	4.3	6.6	19.4	6.3				
ERVL1.25-4	C-RVL1.25-4	#8	4.3	8.0	21.2	7.0				
ERVS1.25-5	C-RVS1.25-5	#10	5.3	8.0	21.2	7.0				
ERVL1.25-5	C-RVL1.25-5	#10	5.3	9.8	23	8.5				
ERVS1.25-6	C-RVS1.25-6	1/4	6.4	9.8	23	8.5				
ERVL1.25-6	C-RVL1.25-6	1/4	6.4	11.6	26.8	11.1				
ERV1.25-8	C-RV1.25-8	5/16	8.4	11.6	27.4	11.1				
ERV1.25-10	C-RV1.25-10	3/8	10.5	13.6	27.4	13.9				
ERV1.25-12	C-RV1.25-12	1/2	13.0	19.2	37.3	16.5				
ERV 2-3	C-RV 2-3	#4	3.2	6.6	17.5	4.3	10.6	4.9	Blue	Cable size: 1.5-2.5mm ² (A.W.G16~14) Max current I _{max} =27A Material: PVC+Copper Plating: Tin
ERVS 2-3.5	C-RVS 2-3.5	#6	3.7	6.6	17.5	4.3				
ERVM 2-3.5	C-RVM 2-3.5	#8	3.7	6.6	20	6.2				
ERVL 2-3.5	C-RVL 2-3.5	#6	3.7	8.5	22.8	7.75				
ERVS 2-4	C-RVS 2-4	#8	4.3	6.6	20	6.2				
ERVL 2-4	C-RVL 2-4	#8	4.3	8.5	22.8	7.75				
ERVS 2-5	C-RVS 2-5	#10	5.3	8.5	22	7.75				
ERVL 2-5	C-RVL 2-5	#10	5.3	9.5	22.6	7.25				
ERVS 2-6	C-RVS 2-6	1/4	6.4	11.9	27.2	11.0				
ERV 2-8	C-RV 2-8	5/16	8.4	11.9	27.2	11.0				
ERV 2-10	C-RV 2-10	3/8	10.5	13.6	31.1	13.9				
ERV 2-12	C-RV 2-12	1/2	13.0	19.2	36.8	16.5				
ERV 3.5-4	C-RV 3.5-4	#8	4.3	8.0	24.5	7.7	13.5	6.2	Black	Cable size: 2.5-4mm ² (A.W.G14-12) Max current I _{max} =37A Material: PVC+Copper Plating:Tin
ERVS 3.5-5	C-RVS 3.5-5	#10	5.3	8.0	24.5	7.7				
ERVL 3.5-5	C-RVL 3.5-5	#10	5.3	12.0	29	7.7				
ERV 3.5-6	C-RV 3.5-6	1/4	6.4	12.0	29	7.7				
ERV 5.5-3.5	C-RV 5.5-3.5	#6	3.7	7.2	22	5.3	13.5	6.7	Yellow	Cable size: 4-6mm ² (A.W.G12~10) Max current I _{max} =48A Material: PVC+Copper Plating:Tin
ERVS 5.5-4	C-RVS 5.5-4	#8	4.3	7.2	22	5.3				
ERVL 5.5-4	C-RVL 5.5-4	#8	4.3	9.5	26.2	8.25				
ERV 5.5-5	C-RV 5.5-5	#10	5.3	9.5	26.2	8.25				
ERVS 5.5-6	C-RVS 5.5-6	1/4	6.4	12.0	32.1	10.7				
ERVL 5.5-6	C-RVL 5.5-6	1/4	6.4	12.0	32.8	13				
ERV 5.5-8	C-RV 5.5-8	5/16	8.4	15.0	34	13.7				
ERV 5.5-10	C-RV 5.5-10	3/8	10.5	15.0	34	13.7				
ERV 5.5-12	C-RV 5.5-12	1/2	13.0	19.2	38.8	16				

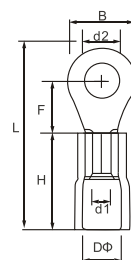

NRV
(Nylon)

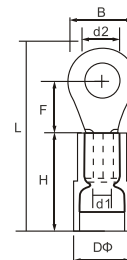

NC-RV
(Nylon+copper sleeve)

Ring Nylon -Insulated Terminal (Copper Seleeve)

Ring Nylon-Insulated Terminal

ITEM NO.		USA SCREW	Screw dia. d2 _Φ (mm)	Dimension(mm)					Color	Explanation
				B	L	F	H	DΦ		
NRV1.25-3	NC-RV1.25-3	#4	3.2	5.7	18.7	4.95	10.6	4.3	Red	Cable size: 0.5-1.5mm ² (A.W.G22~16) Max current: I _{max} =19A Material: Nylon & Copper Thickness: 0.7mm Plating: Tin
NRVS1.25-3.5	NC-RVS1.25-3.5	#6	3.7	5.7	18.7	4.95				
NRVM1.25-3.5	NC-RVM1.25-3.5	#6	3.7	6.6	19.4	6.3				
NRVL1.25-3.5	NC-RVL1.25-3.5	#6	3.7	8.0	21.2	7.0				
NRVS1.25-4	NC-RVS1.25-4	#8	4.3	6.6	19.4	6.3				
NRVL1.25-4	NC-RVL1.25-4	#8	4.3	8.0	21.2	7.0				
NRVS1.25-5	NC-RVS1.25-5	#10	5.3	8.0	21.2	7.0				
NRVL1.25-5	NC-RVL1.25-5	#10	5.3	9.8	23	8.5				
NRVS1.25-6	NC-RVS1.25-6	1/4	6.4	9.8	23	8.5				
NRVL1.25-6	NC-RVL1.25-6	1/4	6.4	11.6	26.8	11.1				
NRV1.25-8	NC-RV1.25-8	5/16	8.4	11.6	27.4	11.1	10.6	4.9	Blue	Cable size: 1.5-2.5mm ² (A.W.G16-14) Max current: I _{max} =27A Material: Nylon & Copper Thickness: 0.8mm Plating: Tin
NRV1.25-10	NC-RV1.25-10	3/8	10.5	13.6	27.4	13.9				
NRV1.25-12	NC-RV1.25-12	1/2	13.0	19.2	37.3	16.5				
NRV 2-3	NC-RV 2-3	#4	3.2	6.6	17.5	4.3				
NRVS 2-3.5	NC-RVS 2-3.5	#6	3.7	6.6	17.5	4.3				
NRVM 2-3.5	NC-RVM 2-3.5	#8	3.7	6.6	20	6.2				
NRVL 2-3.5	NC-RVL 2-3.5	#6	3.7	8.5	22.8	7.75				
NRVS 2-4	NC-RVS 2-4	#8	4.3	6.6	20	6.2				
NRVL 2-4	NC-RVL 2-4	#8	4.3	8.5	22.8	7.75				
NRVS 2-5	NC-RVS 2-5	#10	5.3	8.5	22	7.75				
NRVL 2-5	NC-RVL 2-5	#10	5.3	9.5	22.6	7.25	13.5	6.7	Yellow	Cable size: 4-6mm ² (A.W.G12~10) Max current: I _{max} =48A Material: Nylon & Copper Thickness: 1.7mm Plating: Tin
NRVS 2-6	NC-RVS 2-6	1/4	6.4	11.9	27.2	11.0				
NRV 2-8	NC-RV 2-8	5/16	8.4	11.9	27.2	11.0				
NRV 2-10	NC-RV 2-10	3/8	10.5	13.6	31.1	13.9				
NRV 2-12	NC-RV 2-12	1/2	13.0	19.2	36.8	16.5				
NRV 5.5-3.5	NC-RV 5.5-3.5	#6	3.7	7.2	22	5.3				
NRVS 5.5-4	NC-RVS 5.5-4	#8	4.3	7.2	22	5.3				
NRVL 5.5-4	NC-RVL 5.5-4	#8	4.3	9.5	26.2	8.25				
NRV 5.5-5	NC-RV 5.5-5	#10	5.3	9.5	26.2	8.25				
NRVS 5.5-6	NC-RVS 5.5-6	1/4	6.4	12.0	32.1	10.7				
NRVL 5.5-6	NC-RVL 5.5-6	1/4	6.4	12.0	32.8	13				
NRV 5.5-8	NC-RV 5.5-8	5/16	8.4	15.0	34	13.7				
NRV 5.5-10	NC-RV 5.5-10	3/8	10.5	15.0	34	13.7				
NRV 5.5-12	NC-RV 5.5-12	1/2	13.0	19.2	38.8	16				

Ring Non-Insulated Terminal(TO)

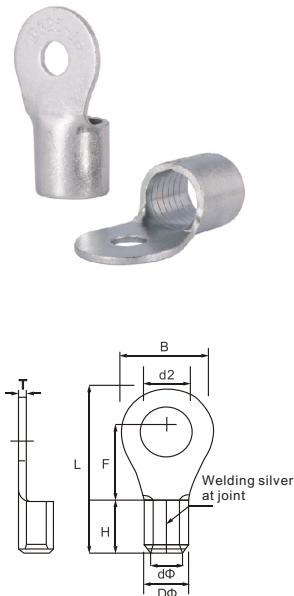

ITEM NO.	USA SCREW	d2Φ (mm)	Dimension(mm)						Explanation
			B	L	F	E	DΦ	dΦ	
RNB1.25-3	#4	3.2	5.7	12.6	4.95	4.8	3.4	1.7	Cable size: 0.5-1.5mm ² (A.W.G22~16) Max current: I _{max} =19A Material: Copper Plating: Tin
RNBS1.25-3.5	#6	3.7	5.7	12.6	4.95				
RNBM1.25-3.5	#6	3.7	6.6	14.4	6.3				
RNBL1.25-3.5	#6	3.7	8.0	15.8	7.0				
RNBS1.25-4	#8	4.3	6.6	14.4	6.3				
RNBL1.25-4	#8	4.3	8.0	15.8	7.0				
RNBS1.25-5	#10	5.3	8.0	15.8	7.0				
RNBL1.25-5	#10	5.3	9.8	18.0	8.3				
RNBS1.25-6	1/4	6.4	9.8	18.8	8.3				
RNBL1.25-6	1/4	6.4	11.6	21.8	11.2				
RNB1.25-8	5/16	8.4	11.6	21.8	11.2				
RNB1.25-10	3/8	10.5	13.6	25.5	13.9				
RNB1.25-12	1/2	13.0	19.2	31.0	16.5				
RNB 2-3	#4	3.2	6.6	12.3	4.2	4.8	4.1	2.3	Cable size: 1.5-2.5mm ² (A.W.G16~14) Max current: I _{max} =27A Material: Copper Plating: Tin
RNBS 2-3.5	#6	3.7	6.6	12.3	4.2				
RNBM 2-3.5	#6	3.7	6.6	16.0	7.9				
RNBL 2-3.5	#6	3.7	8.5	16.8	7.75				
RNBS 2-4	#8	4.3	6.6	16.0	7.9				
RNBL 2-4	#8	4.3	8.5	16.8	7.75				
RNBS 2-5	#10	5.3	8.5	16.8	7.75				
RNBL 2-5	#10	5.3	9.5	16.8	7.25				
RNB 2-6	1/4	6.4	12.0	21.8	11.0				
RNB 2-8	5/16	6.4	12.0	21.8	11.0				
RNB 2-10	3/8	10.5	13.6	25.5	13.9				
RNB 2-12	1/2	13.0	19.2	31.0	16.5				
RNB 3.5-4	#8	4.3	8.0	18.0	7.7	6.0	5.0	3.0	Cable size: 2.5-4mm ² (A.W.G14~12) Max current: I _{max} =37A Material: Copper Plating: Tin
RNBS 3.5-5	#10	5.3	8.0	18.0	7.7				
RNBL 3.5-5	#10	5.3	12.0	21.4	7.7				
RNB 3.5-6	1/4	6.4	12.0	21.4	7.7	6.8	5.6	3.4	Cable size: 4-6mm ² (A.W.G12~10) Max current: I _{max} =48A Material: Copper Plating: Tin
RNB 5.5-3.5	#6	3.7	7.2	15.7	5.3				
RNBS 5.5-4	#8	4.3	7.2	15.7	5.3				
RNBL 5.5-4	#8	4.3	9.5	19.8	8.25				
RNB 5.5-5	#10	5.3	9.5	19.8	8.25				
RNBS 5.5-6	1/4	6.4	12.0	23.35	10.7				
RNBL 5.5-6	1/4	6.4	12.0	25.8	13.0				
RNB 5.5-8	5/16	8.4	15.0	28.0	13.7				
RNB 5.5-10	3/8	10.5	15.0	28.0	13.7	6.8	5.6	3.4	
RNB 5.5-12	1/2	13.0	19.2	32.4	16.0				

Ring Non-Insulated Terminal(TO)

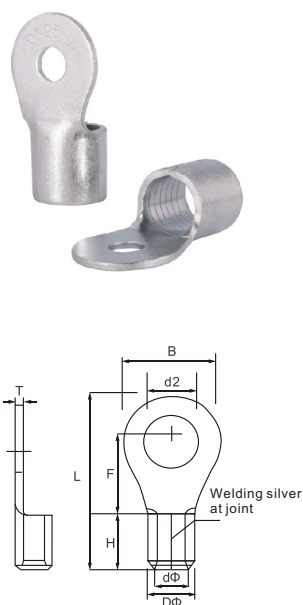

ITEM NO.	USA SCREW	d2Φ (mm)	Dimension(mm)						Explanation
			B	L	F	E	DΦ	dΦ	
RNB 8-4	#8	4.3	8.8	23.8	9.3	8.5	7.2	4.5	Cable size: 6-10mm ² (A.W.G8) Max current: I _{max} =62A Material: Copper Thickness: 1.2mm Plating: Tin
RNBS 8-5	#10	5.3	8.8	23.8	11.1				
RNBM 8-5	#10	5.3	12.0	23.8	9.3				
RNBL 8-5	#10	5.3	15.0	29.8	13.8				
RNBS 8-6	1/4	6.4	12.0	23.8	9.3				
RNBL 8-6	1/4	6.4	15.0	29.8	13.8				
RNB 8-8	5/16	8.4	15.0	29.8	13.8				
RNB 8-10	3/8	10.5	15.0	29.8	13.8				
RNB 8-12	1/2	13.0	20.0	33.5	15.0	10.5	9.5	5.8	Cable size: 10-16mm ² (A.W.G6) Max current: I _{max} =88A Material: Copper Thickness: 1.4mm Plating: Tin
RNB 14-4	#8	4.3	12.0	29.8	13.3				
RNB 14-5	#10	5.3	12.0	29.8	13.3				
RNBS 14-6	1/4	6.4	12.0	29.8	13.3				
RNBL 14-6	1/4	6.4	16.0	32.8	13.3				
RNB 14-8	5/16	8.4	16.0	31.8	13.3				
RNB 14-10	3/8	10.5	16.0	31.8	13.3	12.0	11.5	7.7	Cable size: 16-25mm ² (A.W.G4) Max current: I _{max} =115A Material: Copper Thickness: 1.4mm Plating: Tin
RNB 14-12	1/2	13.0	22.0	41.0	19.5				
RNBS 22-5	#10	4.3	12.2	33.2	15.1				
RNBL 22-5	#10	5.3	16.5	33.7	13.5				
RNBS 22-6	1/4	6.4	12.2	33.2	15.1				
RNBL 22-6	1/4	6.4	16.5	33.7	13.5				
RNB 22-8	5/16	8.4	16.5	33.7	13.5				
RNB 22-10	3/8	10.5	16.5	33.7	13.5	14.0	13.3	9.4	Cable size: 35-50mm ² (A.W.G2) Max current: I _{max} =160A Material: Copper Thickness: 1.8mm Plating: Tin
RNB 22-11	7/16	11.5	22.0	42.5	19.5				
RNB 22-12	1/2	13.0	22.0	42.5	19.5				
RNB 38-5	#10	5.3	15.3	39.0	17.4				
RNB 38-6	1/4	6.4	15.3	39.0	17.4				
RNBS 38-8	5/16	8.4	15.3	39.0	17.4				
RNBL 38-8	5/16	8.4	22.0	42.7	17.7				
RNBS 38-10	3/8	10.5	15.3	39.0	17.4				
RNBL 38-10	3/8	10.5	22.0	42.7	17.7				
RNB 38-11	7/16	11.5	22.0	42.7	17.7				
RNB 38-12	1/2	13.0	22.0	42.7	17.7				

Ring Non-Insulated Terminal(TO)

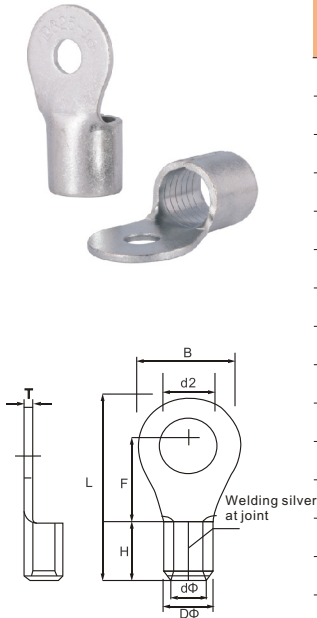

ITEM NO.	USA SCREW	d2Φ (mm)	Dimension(mm)						Explanation
			B	L	F	E	DΦ	dΦ	
RNB 60-6	1/4	6.4	22.0	49.7	20.7	18.0	15.4	11.4	Cable size: 50-70mm ² (A.W.G1/0) Max current: I _{max} =215A Material: Copper Thickness: 1.8mm Plating: Tin
RNB 60-8	5/16	8.4							
RNB 60-10	3/8	10.5							
RNB 60-11	7/16	11.5							
RNB 60-12	1/2	13.0							
RNB 60-14	9/16	15.0	32.0	57.5	23.5	18.0	15.4	11.4	
RNB 60-16	5/8	17.0							
RNB 60-18	11/16	19.0							
RNB 60-20	3/4	21.0							
RNB 60-22	7/8	23.0							
RNB 70-6	1/4	6.4	24.0	51.0	20.0	19.0	17.5	13.3	Cable size: 70-95mm ² (A.W.G2/0) Max current: I _{max} =235A Material: Copper Thickness: 2.0mm Plating: Tin
RNB 70-8	5/16	8.4							
RNB 70-10	3/8	10.5							
RNB 70-11	7/16	11.5							
RNB 70-12	1/2	13.0							
RNB 70-14	9/16	15.0	32.0	61.0	26.0	19.0	17.5	13.3	
RNB 70-16	5/8	17.0							
RNB 70-18	11/16	19.0							
RNB 70-20	3/4	21.0							
RNB 70-22	7/8	23.0							
RNB 80-6	1/4	6.4	27.0	54.2	20.7	20.0	19.5	14.5	Cable size: 95-120mm ² (A.W.G3/0) Max current: I _{max} =255A Material: Copper Thickness: 2.2mm Plating: Tin
RNB 80-8	5/16	8.4							
RNB 80-10	3/8	10.5							
RNB 80-11	7/16	11.5							
RNB 80-12	1/2	13.0							
RNB 80-14	9/16	15.0	32.0	68.0	32.0	20.0	19.5	14.5	
RNB 80-16	5/8	17.0							
RNB 80-18	11/16	19.0							
RNB 80-20	3/4	21.0							
RNB 80-22	7/8	23.0							
RNB 100-6	1/4	6.4	28.5	55.6	20.4	21.0	22.1	16.4	Cable size: 120-150mm ² (A.W.G4/0) Max current: I _{max} =300A Material: Copper Thickness: 2.5mm Plating: Tin
RNB 100-8	5/16	8.4							
RNB 100-10	3/8	10.5							
RNB 100-11	7/16	11.5							
RNB 100-12	1/2	13.0							
RNB 100-14	9/16	15.0	32.0	69.0	32.0	21.0	22.1	16.4	
RNB 100-16	5/8	17.0							
RNB 100-18	11/16	19.0							
RNB 100-20	3/4	21.0							
RNB 100-22	7/8	23.0							

Ring Non-Insulated Terminal(TO)

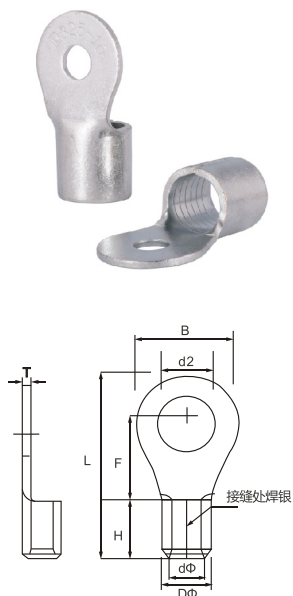

ITEM NO.	USA SCREW	d2Φ (mm)	Dimension(mm)						Explanation
			B	L	F	E	DΦ	dΦ	
RNB 150-8	5/16	8.4	36.0	66.0	23.0	27.0	26.6	19.5	Cable size: 150-185mm ² (A.W.G250/300MCM) Max current: max=395A Material: Copper Thickness: 3.2mm Plating: Tin
RNB 150-10	3/8	10.5							
RNB 150-11	7/16	11.5							
RNB 150-12	1/2	13.0							
RNB 150-14	9/16	15.0							
RNB 150-16	5/8	17.0	36.0	81.0	36.0	27.0	26.6	19.5	
RNB 150-18	11/16	19.0							
RNB 150-20	3/4	21.0							
RNB 150-22	7/8	23.0							
RNB 150-24	15/16	25.0							
RNB 150-27	1	28.0							
RNB 180-8	5/16	8.4	38.5	69.0	24.5	28.5	28.6	21.0	Cable size: 185-240mm ² (A.W.G300/350MCM) Max current: I _{max} =440A Material: Copper Thickness: 3.5mm Plating: Tin
RNB 180-10	3/8	10.5							
RNB 180-11	7/16	11.5							
RNB 180-12	1/2	13.0							
RNB 180-14	9/16	15.0							
RNB 180-16	5/8	17.0	38.5	86.6	39.5	28.5	28.6	21.0	
RNB 180-18	11/16	19.0							
RNB 180-20	3/4	21.0							
RNB 180-22	7/8	23.0							
RNB 180-24	15/16	25.0							
RNB 180-27	1	28.0							
RNB 200-8	5/16	8.4	44.0	72.0	24.5	31.5	32.6	24.0	Cable size: 240-300mm ² (A.W.G400/500MCM) Max current: I _{max} =470A Material: Copper Thickness: 4.0mm Plating: Tin
RNB 200-10	3/8	10.5							
RNB 200-11	7/16	11.5							
RNB 200-12	1/2	13.0							
RNB 200-14	9/16	15.0							
RNB 200-16	5/8	17.0	44.0	91.0	37.5	31.5	32.6	24.0	
RNB 200-18	11/16	19.0							
RNB 200-20	3/4	21.0							
RNB 200-22	7/8	23.0							
RNB 200-24	15/16	25.0							
RNB 200-27	1	28.0							
RNB 325-8	5/16	8.4	50.5	88.0	33.5	35.5	37.1	28.0	Cable size: 300-400mm ² (A.W.G500/600MCM) Max current: I _{max} =650A Material: Copper Thickness: 4.0mm Plating: Tin
RNB 325-10	3/8	10.5							
RNB 325-11	7/16	11.5							
RNB 325-12	1/2	13.0							
RNB 325-14	9/16	15.0							
RNB 325-16	5/8	17.0	50.5	105.6	45.5	35.5	37.1	28.0	
RNB 325-18	11/16	19.0							
RNB 325-20	3/4	21.0							
RNB 325-22	7/8	23.0							
RNB 325-24	15/16	25.0							
RNB 325-27	1	28.0							

Copper Tube Terminal(DTGA&DTGY)

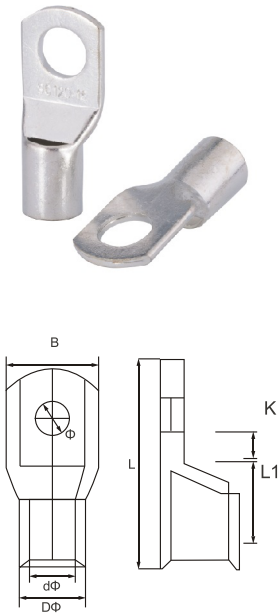

ITEM NO.		d2Φ (mm)	Dimension(mm)				Conductor section (mm ²)	Explanation
DTGA	DTGY		dΦ	DΦ	L1	L		
SC 1.5-5	DTGY 1.5-5	5.3	1.9	3.35	6.5	18.0	1.5	DTGA DTGY DTGB
SC 2.5-4	DTGY 2.5-4	4.3	2.6	4.0	7.0	18.0	2.5	
SC 2.5-5	DTGY 2.5-5	5.3	2.6	4.0	7.0	20.0	2.5	
SC 4-5	DTGY 4-5	5.3	3.2	4.8	7.5	20.5	4	
SC 4-6	DTGY 4-6	6.4	3.2	4.8	7.5	22.0	4	
SC 6-5	DTGY 6-5	5.3	4.1	5.3	8.0	24.0	6	
SC 6-6	DTGY 6-6	6.4	4.1	5.3	8.0	24.0	6	
SC 10-6	DTGY 10-6	6.4	5.1	6.3	9.0	24.0	10	
SC 10-8	DTGY 10-8	8.4	5.1	6.3	9.5	25.0	10	
SC 16-6	DTGY 16-6	6.4	6.4	7.5	11.0	27.5	16	
SC 16-8	DTGY 16-8	8.4	6.4	7.5	11.0	29.5	16	
SC 25-6	DTGY 25-6	6.4	7.4	9.0	13.5	34.0	25	
SC 25-8	DTGY 25-8	8.4	7.4	9.0	13.5	34.0	25	
SC 35-8	DTGY 35-8	8.4	8.5	10.8	14.5	37.0	35	
SC 35-10	DTGY 35-10	10.5	8.5	10.8	14.5	38.0	35	
SC 50-8	DTGY 50-8	8.4	9.6	12.5	17.0	42.5	50	
SC 50-10	DTGY 50-10	10.5	9.6	12.5	17.0	44.0	50	
SC 70-10	DTGY 70-10	10.5	11.9	14.5	19.5	50.0	70	
SC 70-12	DTGY 70-12	13.0	11.9	14.5	19.5	50.0	70	
SC 95-10	DTGY 95-10	10.5	13.2	17.0	23.5	57.0	95	
SC 95-12	DTGY 95-12	13.0	13.2	17.0	23.5	57.0	95	
SC 120-12	DTGY 120-12	13.0	15.6	19.0	26.0	63.0	120	
SC 120-16	DTGY 120-16	17.0	15.6	19.0	26.0	63.0	120	
SC 150-12	DTGY 150-12	13.0	17.4	21.0	29.0	71.0	150	
SC 150-14	DTGY 150-14	15.0	17.4	21.0	29.0	71.0	150	
SC 150-16	DTGY 150-16	17.0	17.4	21.0	29.0	71.0	150	
SC 185-12	DTGY 185-12	13.0	19	23.0	32.0	72.0	185	
SC 185-14	DTGY 185-14	15	19	23.0	32.0	72.0	185	
SC 185-16	DTGY 185-16	17.0	19	23.0	32.0	72.0	185	
SC 240-12	DTGY 240-12	13.0	21.8	26.0	38.0	92.0	240	
SC 240-14	DTGY 240-14	15.0	21.8	26.0	38.0	92.0	240	
SC 240-16	DTGY 240-16	17.0	21.8	26.0	38.0	92.0	240	
SC 240-20	DTGY 240-20	21.0	21.8	26.0	38.0	92.0	240	
SC 300-12	DTGY 300-12	13.0	24.8	30.0	43.0	101.0	300	
SC 300-16	DTGY 300-16	17.0	24.8	30.0	43.0	101.0	300	
SC 300-20	DTGY 300-20	21.0	24.8	30.0	43.0	101.0	300	
SC 400-16	DTGY 400-16	17.0	28.0	34.0	46.0	110.0	400	
SC 400-20	DTGY 400-20	21.0	28.0	34.0	46.0	110.0	400	
SC 500-16	DTGY 500-16	17.0	30.0	38.0	47.0	119.0	500	
SC 500-20	DTGY 500-20	21.0	30.0	38.0	47.0	119.0	500	
SC 630-20	DTGY 630-20	21.0	35.0	45.0	56.0	135.0	630	

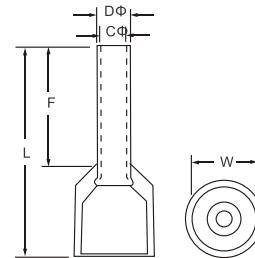

Insulated Cord End Terminal(TG-JT)

ITEM NO.		Dimension(mm)						Conductor section (mm ²)	Color	
PVC	NYLON	F	L	W	DΦ	CΦ	A.W.G		(1) German	(2) French
E 0506	NE 0506	6.0	12.0	3.4	1.3	1.0	#22	0.5	Orange	(1)
E 0508	NE 0508	8.0	14.0						White	(2)
E 0510	NE 0510	10.0	16.0							
E 0512	NE 0512	12.0	18.0							
E 7506	NE 7506	6.0	12.4	3.4	1.5	1.2	#20	0.75	White	(1)
E 7508	NE 7508	8.0	14.4						Blue	(2)
E 7510	NE 7510	10.0	16.4							
E 7512	NE 7512	12.0	18.4							
E 1006	NE 1006	6.0	12.5	3.6	1.7	1.4	#18	1.0	Yellow	(1)
E 1008	NE 1008	8.0	14.5						Red	(2)
E 1010	NE 1010	10.0	16.5							
E 1012	NE 1012	12.0	18.5							
E 1508	NE 1508	8.0	15.4	4.0	2.0	1.7	#16	1.5	Red	(1)
E 1510	NE 1510	10.0	17.4						Black	(2)
E 1512	NE 1512	12.0	19.4							
E 1518	NE 1518	18.0	25.4							
E 2508	NE 2508	8.0	15.0	4.6	2.6	2.3	#14	2.5	Blue	(1)
E 2510	NE 2510	10.0	17.0						Gray	(2)
E 2512	NE 2512	12.0	19.0							
E 2518	NE 2518	18.0	25.0							
E 4009	NE 4009	9.0	17.0	5.5	3.2	2.8	#12	4.0	Gray	(1)
E 4012	NE 4012	12.0	21.0						Orange	(2)
E 4018	NE 4018	18.0	27.0							

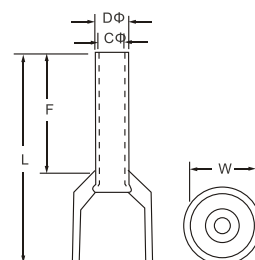

Insulated Cord End Terminal(TG-JT)

ITEM NO.		Dimension(mm)						Conductor section (mm ²)	Color (1)German (2)French
PVC	NYLON	F	L	W	DΦ	CΦ	A.W.G		
E 6010	NE 6010	10.0	19.0	6.7	3.9	3.5	#10	6.0	Black (1)
E 6012	NE 6012	12.0	21.0						Green (2)
E 6018	NE 6018	18.0	26.0						
E 10-12	NE 10-12	12.0	20.8	8.3	4.9	4.5	#7	10.0	Ivory (1)
E 10-18	NE 10-18	18.0	26.8						Brown (2)
E 16-12	NE 16-12	12.0	22.2	9.4	6.2	5.8	#5	16.0	Green (1)
E 16-18	NE 16-18	18.0	27.6						Ivory (2)
E 25-16	NE 25-16	16.0	27.6	11.7	7.9	7.5	#4	25.0	Brown (1)
E 25-22	NE 25-22	22.0	33.5						Black (2)
E 35-16	NE 35-16	16.0	30.0	13.0	8.7	8.3	#2	35.0	Dust-colour (1)
E 35-25	NE 35-25	25.0	39.0						Red (2)
E 50-20	NE 50-20	20.0	35.5	15.8	10.9	10.3	#1	50.0	Olives color (1)
E 50-25	NE 50-25	25.0	40.5						Blue (2)
E 70-20	NE 70-20	20.0	37.0	16.0	14.3	13.5	2/*0	70	Yellow
E 70-25	NE 70-25	25.0	42.0						
E 70-27	NE 70-27	27.0	44.0						
E 95-25	NE 95-25	25.0	43.6	18.2	15.3	14.5	3/0	95	Red
E 120-27	NE 120-27	27.0	47.6	20.3	17.5	16.5	4/4	120	Blue
E 120-32	NE 120-32	32.0	52.6						
E 150-25	NE 150-25	25.0	49.6	23.4	20.6	19.6	250/300	150	Yellow
E150-27	NE150-27	27.0	51.6						
E 150-32	NE 150-32	32.0	56.6						

Non-Insulated Cord End Terminal(TG)



ITEM NO.	Dimension(mm)				Conductor section (mm ²)	
	L1	DΦ	CΦ	W	A.W.G	mm ²
EN 0506	6.0	1.3	1.0	1.7	#22	0.5
EN 0508	8.0					
EN 0510	10.0					
EN 0512	12.0					
EN 7506	6.0	1.5	1.2	1.9	#20	0.75
EN 7508	8.0					
EN 7510	10.0					
EN 7512	12.0					
EN 1006	6.0	1.8	1.4	2.2	#18	1.0
EN 1008	8.0					
EN 1010	10.0					
EN 1012	12.0					
EN 1507	7.0	2.0	1.7	2.5	#16	1.5
EN 1508	8.0					
EN 1510	10.0					
EN 1512	12.0					
EN 1518	18.0	2.6	2.2	3.3	#14	2.5
EN 2507	7.0					
EN 2508	8.0					
EN 2510	10.0					
EN 2512	12.0	3.2	2.8	3.9	#12	4.0
EN 2518	18.0					
EN 4009	9.0					
EN 4012	12.0					
EN 4018	18.0	3.9	3.5	4.8	#10	6.0
EN 6010	10.0					
EN 6012	12.0					
EN 6015	15.0					
EN 6018	18.0	4.9	4.5	5.8	#7	10.0
EN 10-12	12.0					
EN 10-15	15.0					
EN 10-18	18.0					
EN 16-12	12.0	6.2	5.8	7.2	#5	16.0
EN16-15	15.0					
EN 16-18	18.0					
EN 25-16	16.0	7.9	7.5	9.1	#4	25.0
EN 25-22	22.0					
EN 35-16	16.0					
EN 35-25	25.0					
EN 50-20	20.0	10.9	10.3	12.4	#1	50.0
EN 50-25	25.0					

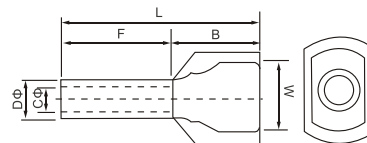

Insulated Twin Cord End Terminal

ITEM NO.	Conductor (mm ²)	Dimension(mm)						Color	
		L1	DΦ	CΦ	W	A.W.G	mm ²	German	French
TE 0508	2x0.5	8.0	14.0	5.0	6.0	1.8	1.5	White	White
TE 7508	2x0.75	8.0	14.5	5.5	6.5	2.1	1.8	Blue	Gray
TE 7510	2x0.75	10.0	16.5	5.5	6.5	2.1	1.8		
TE 1008	2x1.0	8.0	14.9	5.5	6.9	2.3	2.0	Red	Red
TE 1010	2x1.0	10.0	16.9	5.5	6.9	2.3	2.0		
TE 1508	2x1.5	8.0	16.7	6.7	8.7	2.6	2.3	Black	Yellow
TE 1512	2x1.5	12.0	20.7	6.7	8.7	2.6	2.3		
TE 2510	2x2.5	10.0	19.8	8.0	9.8	3.3	2.9	Gray	Blue
TE 2513	2x2.5	13.0	22.8	8.0	9.8	3.3	2.9		
TE 4012	2x4.0	12.0	21.2	8.8	9.2	4.2	3.8	Orange	Gray
TE 6014	2x6.0	14.0	23.5	9.5	9.5	5.3	4.9	Green	Yellow
TE 10-14	2x10.0	14.0	26.5	12.6	12.5	6.9	6.5	Brown	Red
TE 16-14	2x16.0	14.0	30.0	19.0	16.0	8.7	8.3	Ivory	Blue

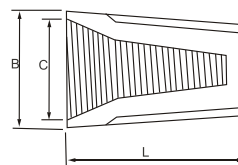

Screw On Wire Connector

ITEM NO.	Lead combination range		Dimension(mm)			Color
			L	B	C	
SP1	Min0.75x1+0.5x1	Max1.5x2	8.5	3.5	14.7	Gray
SP2	Min0.75x3	Max1.5x3	10.1	6.5	17.5	Blue
SP3	Min0.75x3	Max1.5x3+1x1	11.2	8.0	21.4	Orange
SP4	Min0.25x1+0.75x1	Max2.5x4+0.75x1	13.7	7.5	23.6	Yellow
SP6	Min0.25x2	Max6x3+4x2	16.0	7.0	26.5	Red

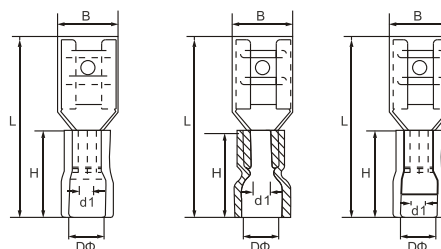

Vinyl-Insulated Female Disconnections

ITEM NO.	connecting spec. (mm)	Thickness of material	Dimension(mm)					AWG	Color	Explanation
			B	DΦ	dΦ	L	H			
FDD1.25-110(5)	0.5x2.8	0.3	3.8	3.8	1.7	18.7	10.6	22-16	Red	Material:PVC+Brass Plating:Tin Note:Nylon(NFDD),Nylon+Copper sleeve(NC-FDD)
FDD1.25-110(8)	0.8x2.8	0.3	3.8	3.8	1.7	18.7	10.6			
FDD1.25-187(5)	0.5x4.75	0.35	5.6	3.8	1.7	18.7	10.6			
FDD1.25-187(8)	0.8x4.75	0.35	5.6	3.8	1.7	18.7	10.6			
FDD1.25-205	0.5x5.2	0.35	6.5	3.8	1.7	20.0	10.6			
FDD1.25-250	0.8x6.35	0.4	7.4	3.8	1.7	21.0	10.6			
FDD 2-110(5)	0.5x2.8	0.3	3.8	4.3	2.3	18.7	10.6	16-14	Blue	
FDD 2-110(8)	0.8x2.8	0.3	3.8	4.3	2.3	18.7	10.6			
FDD 2-187(5)	0.5x4.75	0.35	5.6	4.3	2.3	18.7	10.6			
FDD 2-187(8)	0.8x4.75	0.35	5.6	4.3	2.3	18.7	10.6			
FDD 2-205	0.5x5.2	0.35	6.5	4.3	2.3	19.7	10.6			
FDD 2-250	0.8x6.35	0.4	7.4	4.3	2.3	21.4	10.6			
FDD 2-312	0.8x8.0	0.4	8.9	4.3	2.3	24.1	10.6	12-10	Yellow	
FDD 5.5-250	0.8x6.35	0.4	7.4	5.7	3.4	24.5	13.0			
FDD 5.5-375	1.2x9.4	0.5	10.9	5.7	3.4	29.3	13.5			

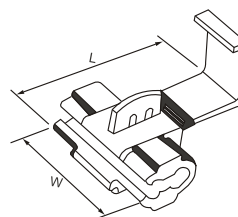
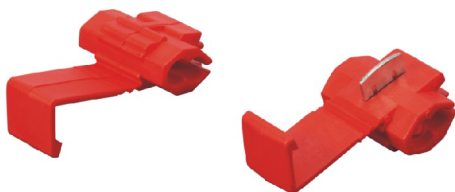

Splice Connector

ITEM NO.	Dimension(mm)		A.W.G	Color
	W	L		
878100	20.0	27.0	22-18A.W.G 0.5-1.0mm ²	Red
878101	20.0	27.0	18-14A.W.G 0.75-2.5mm ²	Blue
878101	20.0	27.0	18-14A.W.G 0.75-2.5mm ²	White
878100	20.5	34.5	12-10A.W.G 4-6mm ²	Yellow

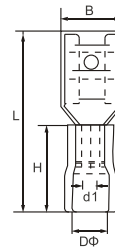

FDD

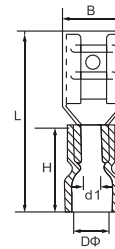

EFDD
(easy entry)

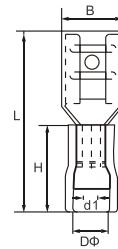

C-FDD
(copper sleeve)

Vinyl-Insulated Female Disconnections

Easy Entry and Copper Sleeve

ITEM NO.		connecting spec. (mm)	Thickness of material	Dimension(mm)					AWG	Color	Explanation
				B	DΦ	dΦ	L	H			
EFDD1.25-110(5)	C-FDD1.25-110(5)	0.5x2.8	0.3	3.8	3.8	1.7	18.7	10.6	22-16	Red	Material: PVC+Brass Plating: Tin Note: Nylon(EFDD),PVC+Copper sleeve(C-FDD)
EFDD1.25-110(8)	C-FDD1.25-110(8)	0.8x2.8	0.3	3.8	3.8	1.7	18.7	10.6			
EFDD1.25-187(5)	C-FDD1.25-187(5)	0.5x4.75	0.35	5.6	3.8	1.7	18.7	10.6			
EFDD1.25-187(8)	C-FDD1.25-187(8)	0.8x4.75	0.35	5.6	3.8	1.7	18.7	10.6			
EFDD1.25-205	C-FDD1.25-205	0.5x5.2	0.35	6.5	3.8	1.7	20.0	10.6			
EFDD1.25-250	C-FDD1.25-250	0.8x6.35	0.4	7.4	3.8	1.7	21.0	10.6			
EFDD 2-110(5)	C-FDD 2-110(5)	0.5x2.8	0.3	3.8	4.3	2.3	18.7	10.6	16-14	Blue	
EFDD 2-110(8)	C-FDD 2-110(8)	0.8x2.8	0.3	3.8	4.3	2.3	18.7	10.6			
EFDD 2-187(5)	C-FDD 2-187(5)	0.5x4.75	0.35	5.6	4.3	2.3	18.7	10.6			
EFDD 2-187(8)	C-FDD 2-187(8)	0.8x4.75	0.35	5.6	4.3	2.3	18.7	10.6			
EFDD 2-205	C-FDD 2-205	0.5x5.2	0.35	6.5	4.3	2.3	19.7	10.6			
EFDD 2-250	C-FDD 2-250	0.8x6.35	0.4	7.4	4.3	2.3	21.4	10.6			
EFDD 2-312	C-FDD 2-312	0.8x8.0	0.4	8.9	4.3	2.3	24.1	10.6	12-10	Yellow	
EFDD 5.5-250	C-FDD 5.5-250	0.8x6.35	0.4	7.4	5.7	3.4	24.5	13.0			
EFDD 5.5-375	C-FDD 5.5-375	1.2x9.4	0.5	10.9	5.7	3.4	29.3	13.5			

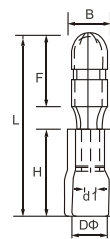

MPD

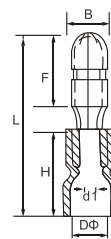

EMPD
(easy entry)

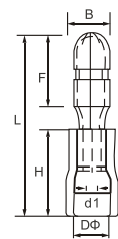

C-MPD
(copper sleeve)

Vinyl-Insulated Bullet Disconnections

Easy Entry and Copper Sleeve

ITEM NO.			Thickness of material	Dimension(mm)					AWG	Color	Explanation
				bΦ	F	DΦ	H	L			
MPD 1.25-156	EMPD 1.25-156	C-MPD 1.25-156	0.4	4.0	10.6	1.7	10.6	21.2	22-16	Red	Material: PVC+Brass Plating: Tin Note:Normal(MPD), Easy entry(EMPD), Copper sleeve(C-MPD)
MPD 2-156	EMPD 2-156	C-MPD 2-156	0.4	4.0	10.6	2.3	12.6	21.2	16-14	Blue	
MPD 2-195	EMPD 2-195	C-MPD 2-195	0.4	5.0	10.6	2.3	10.0	21.2			
MPD 5.5-195	EMPD 5.5-195	C-MPD 5.5-195	0.4	5.0	12.0	3.4	13.5	25.5	12-10	Yellow	

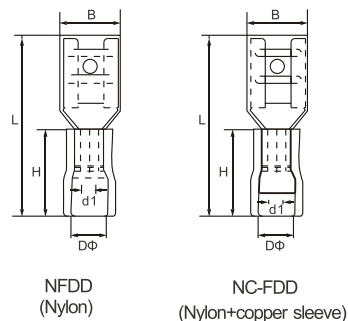

Nylon -Insulated Female Disconnections

ITEM NO.		connecting spec. (mm)	Thickness of material	Dimension(mm)					AWG	Color	Explanation
				B	DΦ	dΦ	L	H			
NFDD1.25-110(5)	NC-FDD1.25-110(5)	0.5x2.8	0.3	3.8	3.8	1.7	18.7	10.6	16-14	Red	Material:Nylon+Brass Plating:Tin Note:Nylon(NFDD),Nylon+ Copper sleeve(NC-FDD)
NFDD1.25-110(8)	NC-FDD1.25-110(8)	0.8x2.8	0.3	3.8	3.8	1.7	18.7	10.6			
NFDD1.25-187(5)	NC-FDD1.25-187(5)	0.5x4.75	0.35	5.6	3.8	1.7	18.7	10.6			
NFDD1.25-187(8)	NC-FDD1.25-187(8)	0.8x4.75	0.35	5.6	3.8	1.7	18.7	10.6			
NFDD1.25-205	NC-FDD1.25-205	0.5x5.2	0.35	6.5	3.8	1.7	20.0	10.6			
NFDD1.25-250	NC-FDD1.25-250	0.8x6.35	0.4	7.4	3.8	1.7	21.0	10.6			
NFDD 2-110(5)	NC-FDD 2-110(5)	0.5x2.8	0.3	3.8	4.3	2.3	18.7	10.6	12-10	Blue	
NFDD 2-110(8)	NC-FDD 2-110(8)	0.8x2.8	0.3	3.8	4.3	2.3	18.7	10.6			
NFDD 2-187(5)	NC-FDD 2-187(5)	0.5x4.75	0.35	5.6	4.3	2.3	18.7	10.6			
NFDD 2-187(8)	NC-FDD 2-187(8)	0.8x4.75	0.35	5.6	4.3	2.3	18.7	10.6			
NFDD 2-205	NC-FDD 2-205	0.5x5.2	0.35	6.5	4.3	2.3	19.7	10.6			
NFDD 2-250	NC-FDD 2-250	0.8x6.35	0.4	7.4	4.3	2.3	21.4	10.6			
NFDD 2-312	NC-FDD 2-312	0.8x8.0	0.4	8.9	4.3	2.3	24.1	10.6	22-16	Yellow	
NFDD 5.5-250	NC-FDD 5.5-250	0.8x6.35	0.4	7.4	5.7	3.4	24.5	13.0			
NFDD 5.5-375	NC-FDD 5.5-375	1.2x9.4	0.5	10.9	5.7	3.4	29.3	13.5			

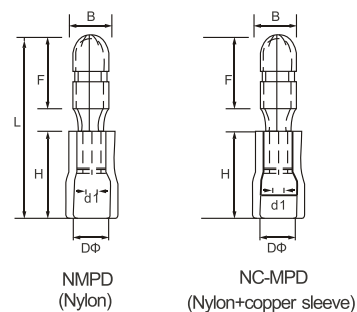

Nylon-Insulated Bullet Disconnections

ITEM NO.		Thickness of material	Dimension(mm)					AWG	Color	Explanation
			bΦ	F	DΦ	H	L			
NMPD 1.25-156	NC-MPD 1.25-156	0.4	4.0	10.6	1.7	10.6	21.2	22-16	Red	Material: PVC+Brass Plating: Tin Note: Normal(MPD),Easy entry(EMPD), Copper sleeve(C-MPD)
NMPD 2-156	NC-MPD 2-156	0.4	4.0	10.6	2.3	12.6	21.2	16-14	Blue	
NMPD 2-195	NC-MPD 2-195	0.4	5.0	10.6	2.3	10.0	21.2			
NMPD 5.5-195	NC-MPD 5.5-195	0.4	5.0	12.0	3.4	13.5	25.5	12-10	Yellow	

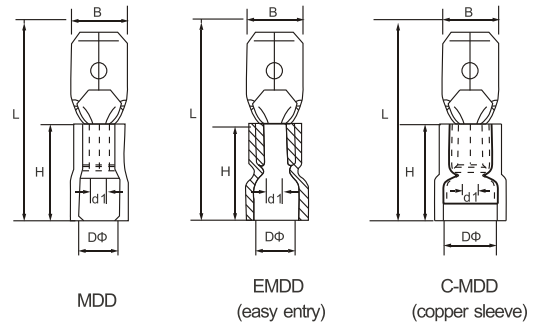

Vinyl-Insulated Male Disconnections

Easy Entry and Copper Sleeve

ITEM NO.			Nema Tab (mm)	Thickness of material	Dimension(mm)					AWG	Color	Explanation
					B	DΦ	dΦ	L	H			
MDD1.25-110(5)	EMDD1.25-110(5)	C-MDD1.25-110(5)	0.5x2.8	0.5	2.8	4.3	1.7	17.7	10.6	22-16	Red	Material:PVC+Brass Plating:Tin Note:Normal(MDD),Easy entry(EMDD),Copper sleeve(C-MDD)
MDD1.25-110(8)	EMDD1.25-110(8)	C-MDD1.25-110(8)	0.8x2.8	0.8	2.8	4.3	1.7	17.7	10.6			
MDD1.25-187(5)	EMDD1.25-187(5)	C-MDD1.25-187(5)	0.5x4.75	0.5	4.75	4.3	1.7	20.0	10.6			
MDD1.25-187(8)	EMDD1.25-187(8)	C-MDD1.25-187(8)	0.8x4.75	0.8	4.75	4.3	1.7	20.0	10.6			
MDD1.25-250	EMDD1.25-250	C-MDD1.25-250	0.8x6.35	0.4x2	6.35	4.3	1.7	21.6	10.6			
MDD 2-187(5)	EMDD 2-187(5)	C-MDD 2-187(5)	0.5x4.75	0.5	4.75	4.3	2.3	20.0	20.0	16-14	Blue	
MDD 2-187(8)	EMDD 2-187(8)	C-MDD 2-187(8)	0.8x4.75	0.8	4.75	4.3	2.3	20.0	20.0			
MDD 2-250	EMDD 2-250	C-MDD 2-250	0.8x6.35	0.4x2	6.35	4.3	2.3	21.6	21.6			
MDD 5.5-250	EMDD 5.5-250	C-MDD 5.5-250	0.8x6.35	0.4x2	6.35	5.7	3.4	25.5	13.5	12-10	Yellow	

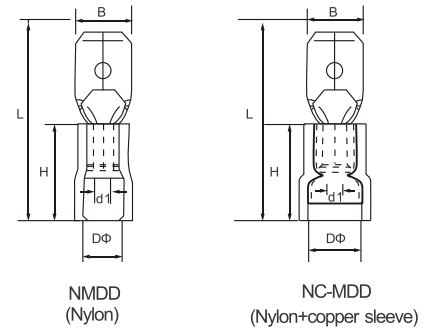

Nylon-Insulated Male Disconnections

ITEM NO.		Nema Tab (mm)	Thickness of material	Dimension(mm)					AWG	Color	Explanation
				B	DΦ	dΦ	L	H			
NMDD1.25-110(5)	NC-MDD1.25-110(5)	0.5x2.8	0.5	2.8	4.3	1.7	17.7	10.6	22-16	Red	Material: PVC+Brass Plating: Tin Note: Nylon(NMDD),Nylon+Copper sleeve (NC-MDD)
NMDD1.25-110(8)	NC-MDD1.25-110(8)	0.8x2.8	0.8	2.8	4.3	1.7	17.7	10.6			
NMDD1.25-187(5)	NC-MDD1.25-187(5)	0.5x4.75	0.5	4.75	4.3	1.7	20.0	10.6			
NMDD1.25-187(8)	NC-MDD1.25-187(8)	0.8x4.75	0.8	4.75	4.3	1.7	20.0	10.6			
NMDD1.25-250	NC-MDD1.25-250	0.8x6.35	0.4x2	6.35	4.3	1.7	21.6	10.6			
NMDD 2-187(5)	NC-MDD 2-187(5)	0.5x4.75	0.5	4.75	4.3	2.3	20.0	10.6	16-14	Blue	
NMDD 2-187(8)	NC-MDD 2-187(8)	0.8x4.75	0.8	4.75	4.3	2.3	20.0	10.6			
NMDD 2-250	NC-MDD 2-250	0.8x6.35	0.4x2	6.35	4.3	2.3	21.6	10.6			
NMDD 5.5-250	NC-MDD 5.5-250	0.8x6.35	0.4x2	6.35	5.7	3.4	25.5	13.5	12-10	Yellow	



Vinyl Fully Insulated Female Disconnections

ITEM NO.	Nema Tab (mm)	Dimension(mm)				AWG	Explanation
		B	DΦ	dΦ	L		
FDFD1.25-187(5)	0.5x4.75	5.6	3.8	1.7	20.8	22-16	Cable size: 0.5-1.5mm ² Max current: I _{max} =27A Material: Copper Plating: Tin
FDFD1.25-187(8)	0.8x4.75	5.6	3.8	1.7	20.8		
FDFD1.25-250	0.8x6.35	7.4	3.8	1.7	24.3		
FDFD 2-187(5)	0.5x4.75	5.6	4.3	2.3	20.8		
FDFD 2-187(8)	0.8x4.75	5.6	4.3	2.3	20.8		
FDFD 2-250	0.8x6.35	7.4	4.3	2.3	24.3		
FDFD 5.5-250	0.8x6.35	7.4	5.7	3.4	24.3		



Vinyl Fully Insulated Receptacle Disconnections

ITEM NO.	Thickness of material	Dimension(mm)					Color	AWG	Explanation
		bΦ	BΦ	DΦ	F	L			
FRD 1.25-156	0.4	4.0	6.3	1.7	13.0	24.5	Red	22-16	Cable size: 0.5-1.5mm ² Max current: I _{max} =27A Material: Copper Plating:Tin
FRD 2-156	0.4	4.0	6.3	2.3	14.0	24.5	Blue		
FRD 2-195	0.4	5.0	7.0	2.3	14.0	25.5			
FRD 5.5-195	0.4	5.0	7.0	3.4	14.0	24.5	Yellow		

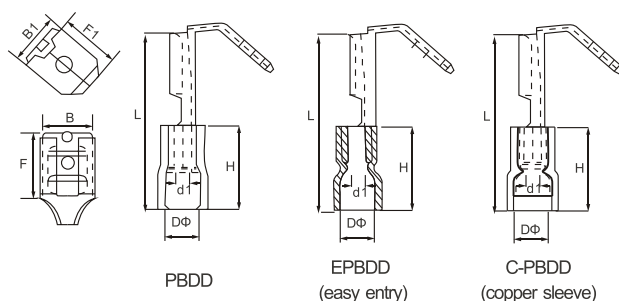

Vinyl-Insulated Piggy-Back Disconnections

ITEM NO.			Nema Tab (mm)	Dimension(mm)						Explanation
				B	B1	H	DΦ	dΦ	L	
PBDD 1.25-250	EPBDD 1.25-250	C-PBDD 1.25-250	0.8x6.35	7.4	6.3	10.6	3.8	1.7	21.0	Material: PVC+Brass Plating: Tin Note: Normal(PBDD),Easy entry(EPBDD),Copper sleeve(C-PBDD)
PBDD 2-250	EPBDD 2-250	C-PBDD 2-250	0.86.35	7.7	6.3	10.6	4.3	2.3	21.0	
PBDD 5.5-250	EPBDD 5.5-250	C-PBDD 5.5-250	0.8x6.35	7.7	6.3	13.5	5.7	3.4	23.5	

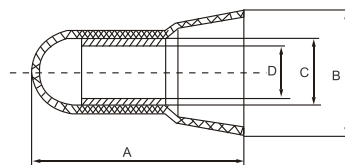

Shell material:Nylon 66,94V-2,certificated agree by UL.Usage:peel the coat of wire,then insert to tube, use pincers to fix them.feature:Nylon shell,long copper tube,easy to conduct electricity and hold wire tightly.

Close-End Wire Connector

ITEM NO.	Nema Tab (mm)	W (mm)		D (mm)	Suitable Wires		Packing	Explanation
		B	C		mm ²	AWG		
DL-Φ3	17.8	7.2	3.6	2.5	1.25	22-16	100PCS& 1000PCS	Cable size: 0.5-1.5mm ² (A.W.G22~16) Max current: I _{max} =27A Material: Copper Plating: Tin
DL-Φ4	21.0	8.2	4.0	2.9	2.0	16-14		
DL-Φ5	22.5	9.0	4.8	3.9	5.5	12-10		
DL-Φ6	25.0	10.0	5.6	4.5	8.0	8		
DL-Φ7	24.2	11.0	6.5	5.4	10	8-6	100PCS& 500PCS	
DL-Φ8	25.6	11.8	7.5	6.0	13	6		
DL-Φ10	29.5	13.5	9.3	7.5	16	4	100PCS	

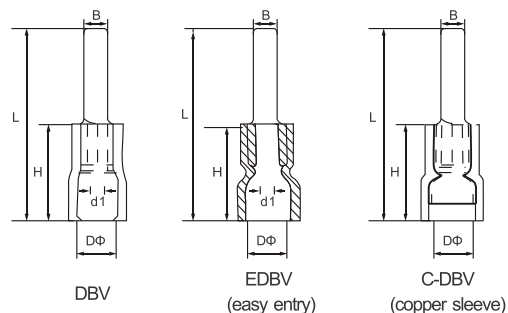

Vinyl -Insulated Blade Terminal

Easy Entry and Copper Sleeve

ITEM NO.			Dimension(mm)					AWG	T	Color	Explanation
			B	L	F	H	DΦ				
DBV 1.25-10	EDBV 1.25-10	C-DBV 1.25-10	2.3	20.6	10.0	10.6	4.3	22-16	0.7	Red	Material: pvc+red copper Plating:Tin Note:Normal(DBV),Easy entry(EDBV),Copper sleeve(C-DBV)
DBV 1.25-11	EDBV 1.25-11	C-DBV 1.25-11	2.3	21.6	11.0						
DBV 1.25-14	EDBV 1.25-14	C-DBV 1.25-14	2.3	24.6	14.0						
DBV 1.25-18	EDBV 1.25-18	C-DBV 1.25-18	2.3	28.6	18.0						
DBV 2-10	EDBV 2-10	C-DBV 2-10	2.55	20.5	9.9	10.6	4.9	16-14	0.8	Blue	
DBV 2-14	EDBV 2-14	C-DBV 2-14	2.55	24.6	14.0						
DBV 2-18	EDBV 2-18	C-DBV 2-18	2.55	28.6	18.0						
DBV 5.5-10	EDBV 5.5-10	C-DBV 5.5-10	2.8	23.3	9.8	13.5	5.6	12-10	1.0	Yellow	
DBV 5.5-14	EDBV 5.5-14	C-DBV 5.5-14	4.5	27.3	13.8						
DBV 5.5-18	EDBV 5.5-18	C-DBV 5.5-18	4.5	31.3	17.8						

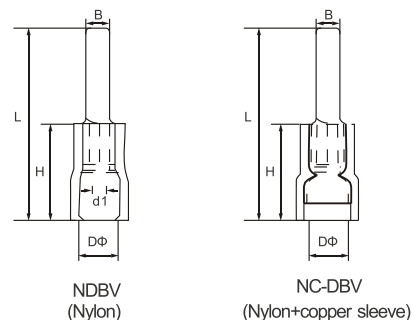

Nylon -Insulated Blade Terminal

ITEM NO.		Dimension(mm)					AWG	T	Color	Explanation
		B	L	F	H	DΦ				
NDBV 1.25-10	NC-DBV 1.25-10	2.3	20.6	10.0	10.6	4.3	22-16	0.7	Red	Material: NYLON+COPPER Plating: Tin Note:Nylon(NDBV,Nylon+Copper sleeve(NC-DBV)
NDBV 1.25-11	NC-DBV 1.25-11	2.3	21.6	11.0						
NDBV 1.25-14	NC-DBV 1.25-14	2.3	24.6	14.0						
NDBV 1.25-18	NC-DBV 1.25-18	2.3	28.6	18.0						
NDBV 2-10	NC-DBV 2-10	2.55	20.5	9.9	10.6	4.9	16-14	0.8	Blue	
NDBV 2-14	NC-DBV 2-14	2.55	24.6	14.0						
NDBV 2-18	NC-DBV 2-18	2.55	28.6	18.0						
NDBV 5.5-10	NC-DBV 5.5-10	2.8	23.3	9.8	13.5	5.6	12-10	1.0	Yellow	
NDBV 5.5-14	NC-DBV 5.5-14	4.5	27.3	13.8						
NDBV 5.5-18	NC-DBV 5.5-18	4.5	31.3	17.8						

Non-Isulated Blade Terminal

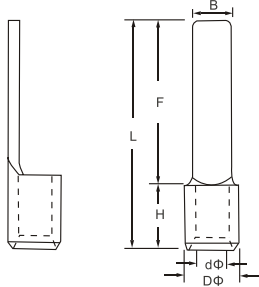

ITEM NO.	Dimension(mm)						Explanation
	B	L	F	E	DΦ	dΦ	
DBN 1.25-10	2.4	14.8	10.0	4.8	3.4	1.7	Cable size: 0.5-1.5mm² (A.W.G22~16) Max current: I _{max} =27A Material: Copper Plating: Tin
DBN 1.25-11	2.4	15.8	11.0				
DBN 1.25-14	2.4	18.8	14.0				
DBN 1.25-18	2.4	22.8	18.0				
DBN 2-9	2.5	14.6	9.9	4.8	4.1	2.3	
DBN 2-18	2.5	22.8	18.0				
DBN 5.5-10	2.8	14.8	10.0	6.0	5.6	3.4	
DBN 5.5-14	4.5	21.0	14.0				
DBN 5.5-18	4.5	23.0	18.0				
DBN 8-14	5.0	22.5	14.0	8.5	7.2	4.5	
DBN 14-16	6.0	30.6	16.0	14.0	9.0	6.5	

Non-Isulated Pin Terminal

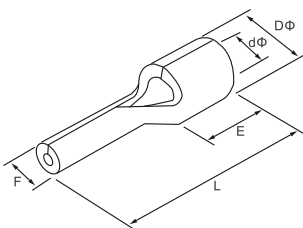

ITEM NO.	Dimension(mm)					Explanation
	F	L	E	DΦ	dΦ	
PTN 1.25-9	1.9	13.8	4.8	3.4	1.7	Cable size: 0.5-1.5mm ² (A.W.G22~16) Max current: I _{max} =27A Material: Copper Plating: Tin
PTN 1.25-10	1.9	14.8				
PTN 1.25-12	1.9	16.8				
PTN 1.25-13	1.9	17.8				
PTN 1.25-18	1.9	22.8				
PTN 2-9	1.9	13.8	4.8	4.1	2.3	
PTN 2-10	1.9	14.8				
PTN 2-12	1.9	16.8				
PTN 2-13	1.9	17.8				
PTN 2-18	1.9	22.8				
PTN 3.5-10	2.8	14.8	6.0	5.0	3.0	
PTN 3.5-13	2.8	19.8				
PTN 5.5-13	2.8	19.8	6.0	5.6	3.4	

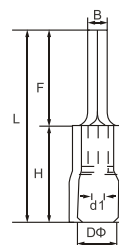

PTV

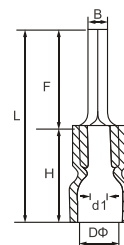

EPTV
(easy entry)

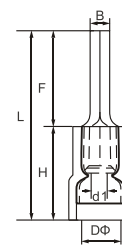

C-PTV
(copper sleeve)

Vinyl-Insulated PIN Terminal

Easy Entry and Copper Sleeve

ITEM NO.			Dimension(mm)				AWG	Color	Explanation
			F	L	H	DΦ			
PTV1.25-9	EPTV1.25-9	C-PTV1.25-9	1.9	19.0	10.6	4.3	22-16	Red	Material: PVC+COPPER Plating: Tin Note: Normal(PTV),Easy entry(EPTVCopper sleeve(C-PTV)
PTV1.25-10	EPTV1.25-10	C-PTV1.25-10	1.9	20.6					
PTV1.25-12	EPTV1.25-12	C-PTV1.25-12	1.9	22.6					
PTV1.25-13	EPTV1.25-13	C-PTV1.25-13	1.9	23.6					
PTV1.25-18	EPTV1.25-18	C-PTV1.25-18	1.9	28.6					
PTV 2-9	EPTV 2-9	C-PTV 2-9	1.9	19.0	10.6	4.9	16-14	Blue	
PTV 2-10	EPTV 2-10	C-PTV 2-10	1.9	20.6					
PTV 2-12	EPTV 2-12	C-PTV 2-12	1.9	22.0					
PTV 2-13	EPTV 2-13	C-PTV 2-13	1.9	23.6					
PTV 2-18	EPTV 2-18	C-PTV 2-18	1.9	28.6					
PTV 3.5-10	EPTV 3.5-10	C-PTV 3.5-10	2.8	20.0	13.0	6.2	12-10	Black	
PTV 3.5-12	EPTV 3.5-12	C-PTV 3.5-12	2.8	25.5					
PTV 5.5-13	EPTV 5.5-13	C-PTV 5.5-13	2.8	26.0	13.5	6.7	12-10	Yellow	

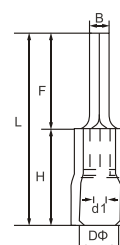

NPTV
(Nylon)

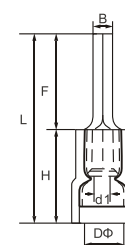

NC-PTV
(Nylon+copper sleeve)

Nylon-Insulated PIN Terminal

ITEM NO.		Dimension(mm)				AWG	Color	Explanation
		F	L	H	DΦ			
NPTV1.25-9	NC-PTV1.25-9	1.9	19.0	10.6	4.3	22-16	Red	Material: PVC+COPPER Plating: Tin Note: Nylon(NPTV),Nylon+Copper sleeve(NC-PTV)
NPTV1.25-10	NC-PTV1.25-10	1.9	20.6					
NPTV1.25-12	NC-PTV1.25-12	1.9	22.6					
NPTV1.25-13	NC-PTV1.25-13	1.9	23.6					
NPTV1.25-18	NC-PTV1.25-18	1.9	28.6					
NPTV 2-9	NC-PTV 2-9	1.9	19.0	10.6	4.9	16-14	Blue	
NPTV 2-10	NC-PTV 2-10	1.9	20.6					
NPTV 2-12	NC-PTV 2-12	1.9	22.0					
NPTV 2-13	NC-PTV 2-13	1.9	23.6					
NPTV 2-18	NC-PTV 2-18	1.9	28.6					
NPTV 5.5-13	NC-PTV 5.5-13	2.8	26.0	13.5	6.7	12-10	Yellow	

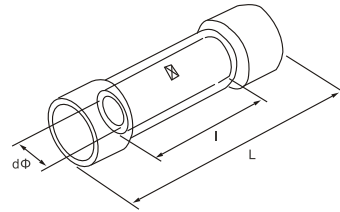

Vinyl-Insulated Butt Splice Terminal(TL-JTK)

ITEM NO.	Conductor section		Dimension(mm)			Imax	Color	Explanation
	A.W.G	mm ²	I	dΦ	L			
BV 1.25	22-16	0.5-1.5	15.0	1.7	25.0	19A	Red	Cable size: 0.5-1.5mm ² (A.W.G22~16) Max current: Imax=27A Material: Copper Plating:Tin
BV 2	16-14	1.5-2.5	15.0	2.3	25.0	27A	Blue	
BV 5.5	12-10	4-6	15.0	3.4	25.0	48A	Yellow	
BV 8	#8	6-10	21.0	4.5	32.0	62A	Red	
BV 14	#6	10-16	26.0	5.8	42.0	88A	Blue	
BV 22	#4	16-25	29.0	7.7	50.0	115A	Yellow	
BV 38	#2	35-50	32.0	9.4	55.0	160A	Red	
PVT 1.25	22-16	0.5-1.5	8.0	1.7	16.0	19A	Red	
PVT 2	16-14	1.5-2.5	8.0	2.3	16.0	27A	Blue	
PVT 5.5	12-10	4-6	8.0	3.4	20.5	48A	Yellow	

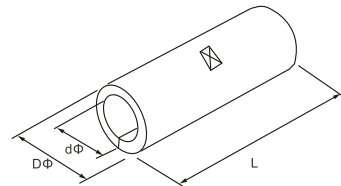

Non-Insulated Butt Splice Terminal

ITEM NO.	Conductor section		Dimension(mm)			Explanation
	A.W.G	mm ²	DΦ	dΦ	L	
BN 1.25	22-16	0.5-1.5	3.3	1.7	15.0	Cable size: 0.5-1.5mm ² (A.W.G22~16) Max current: Imax=27A Material: Copper Plating:Tin
BN 2	16-14	1.5-2.5	4.0	2.3	15.0	
BN 3.5	14-12	2.5-4	5.0	3.0	15.0	
BN 5.5	12-10	4-6	5.5	3.4	15.0	
BN 8	#8	10	7.1	4.5	21.0	
BN 14	#6	16	9.0	5.8	26.0	
BN 22	#4	25	11.4	7.7	29.0	
BN 38	#2	35	13.3	9.4	32.0	
BN 60	1/0	50	15.4	11.4	36.0	
BN 70	2/0	70	17.5	13.3	37.0	
BN 80	3/0	95	19.4	14.5	38.0	
BN 100	4/0	120	22.0	16.4	38.0	
BN 150	250-300MCM	150	26.5	19.5	54.0	
BN 180	300-350MCM	185	28.5	21.0	57.0	
BN 200	400MCM	240	32.5	24.0	63.0	
BN 325	500-600MCM	300	37.0	28.0	72.0	

Locking Spade Vinyl-Insulated Terminal

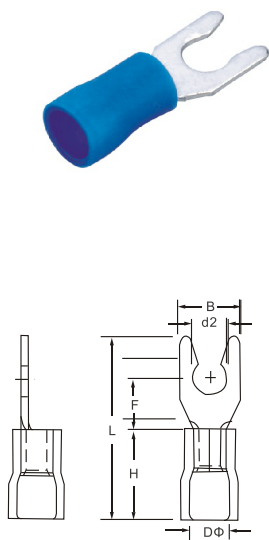

ITEM NO.	USA SCREW	d2Φ (mm)	Dimension(mm)					Color	Explanation
			B	L	F	H	DΦ		
LSV 1.25-3.5	#6	3.7	6.4	21.2	6.5	10.0	4.3	Red	Cable size: 0.5-1.5mm ² (A.W.G22~16) Max current: I _{max} =27A Material: Copper Plating: Tin
LSVS 1.25-4	#8	4.3	7.2	21.2	6.5				
LSVL 1.25-4	#8	4.3	8.1	21.2	6.5				
LSVS 1.25-5	#10	5.3	8.1	21.2	6.5				
LSVL 1.25-5	#10	5.3	9.5	21.2	6.5				
LSV 2-3.5	#6	3.7	6.0	21.2	6.5	10.0	4.9	Blue	Cable size: 0.5-1.5mm ² (A.W.G22~16) Max current: I _{max} =27A Material: Copper Plating: Tin
LSVS 2-4	#8	4.3	7.2	21.2	6.5				
LSVL 2-4	#8	4.3	8.1	21.2	6.5				
LSVS 2-5	#10	5.3	8.1	21.2	6.5				
LSVL 2-5	#10	5.3	9.5	21.2	6.5				
LSV 5.5-3.5	#6	3.7	8.3	25.2	7.5	13.0	6.7	Yellow	Cable size: 0.5-1.5mm ² (A.W.G22~16) Max current: I _{max} =27A Material: Copper Plating: Tin
LSV 5.5-4	#8	4.3	8.3	25.2	7.5				
LSV 5.5-4	#10	5.3	9.0	23.9	7.5				
LSV 5.5-5	1/4	6.4	12.0	31.2	12.0				

Hook Ring Vinyl-Insulated Terminal

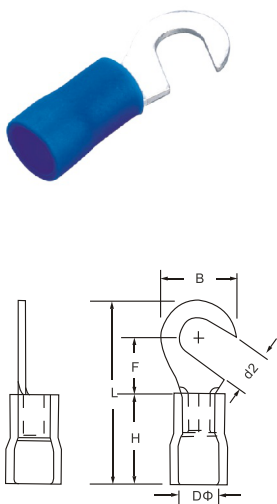

ITEM NO.	USA SCREW	d2Φ (mm)	Dimension(mm)					Color	Explanation
			B	L	F	H	DΦ		
HV1.25-3.5	#6	3.7	8.0	21.0	7.0	10.0	4.3	Red	Cable size: 0.5-1.5mm ² (A.W.G22~16) Max current: I _{max} =27A Material: Copper Plating: Tin
HV1.25-4	#8	4.3	8.0	21.0	7.0				
HV1.25-5	#10	5.3	8.0	21.0	7.0				
HV1.25-6	1/4	6.4	11.6	27.0	11.1				
HV2-3.5	#6	3.7	8.5	22.0	7.75	10.0	4.9	Blue	Cable size: 0.5-1.5mm ² (A.W.G22~16) Max current: I _{max} =27A Material: Copper Plating: Tin
HV2-4	#8	4.3	8.5	22.0	7.75				
HV2-5	#10	5.3	9.5	22.0	7.25				
HV2-6	1/4	6.4	12.0	27.0	11.0				
HV5.5-3.5	#6	3.7	7.2	21.4	5.9	13.0	6.7	Yellow	Cable size: 0.5-1.5mm ² (A.W.G22~16) Max current: I _{max} =27A Material: Copper Plating: Tin
HV5.5-4	#8	4.3	9.5	25.5	8.25				
HV5.5-5	#10	5.3	9.5	25.5	8.25				
HV5.5-6	1/4	6.4	12.0	31.5	13.0				

Locking Spade Non-Insulated Terminal

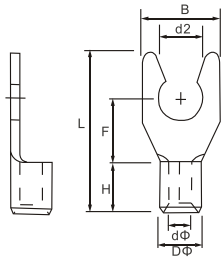

ITEM NO.	d2Φ (mm)	Dimension(mm)						A.W.G mm ²	Explanation
		B	F	L	E	DΦ	dΦ		
LSNB1.25-3.5	3.7	6.4	6.5	16.0	4.8	3.4	1.7	22-16A.W.G. 0.5-1.5mm ²	Cable size: 0.5-1.5mm ² (A.W.G22~16) Max current: I _{max} =27A Material:Copper Plating:Tin
LSNBS1.25-4	4.3	7.2							
LSNBL1.25-4	4.3	8.1							
LSNBS1.25-5	5.3	8.1							
LSNBL1.25-5	5.3	9.5	6.5	16.0	4.8	3.4	2.3	16-14A.W.G. 1.5-2.5mm ²	Cable size: 0.5-1.5mm ² (A.W.G22~16) Max current: I _{max} =27A Material:Copper Plating:Tin
LSNB 2-3.5	3.7	6.0							
LSNBS 2-4	4.3	7.2							
LSNBL 2-4	4.3	8.1							
LSNBS 2-5	5.3	8.1	7.5	19.5	6.0	5.6	3.4	12-10A.W.G. 4-6mm ²	Cable size: 0.5-1.5mm ² (A.W.G22~16) Max current: I _{max} =27A Material:Copper Plating:Tin
LSNBL 2-5	5.3	9.5							
LSNB 5.5-3.5	3.7	8.3							
LSNB 5.5-4	4.3	8.3							
LSNB 5.5-5	5.3	9.0	12.0	24.5					
LSNB 5.5-6	6.4	12.0							

Hook Ring Non-Insulated Terminal

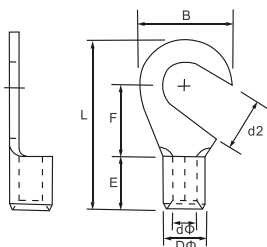

ITEM NO.	d2Φ (mm)	Dimension(mm)						A.W.G mm ²	Explanation
		B	F	L	E	DΦ	dΦ		
HNB1.25-3.5	3.7	8.0	7.0	15.8	4.8	3.4	1.7	12-16A.W.G. 0.5-1.5mm ²	Cable size: 0.5-1.5mm ² (A.W.G22~16) Max currentI _{max} =27A Material:Copper Plating:Tin
HNB1.25-4	4.3								
HNB1.25-5	5.3								
HNB1.25-6	6.4	11.6	11.0	21.8	4.8	4.1	2.3	16-14A.W.G. 1.5-2.5mm ²	
HNB2.5-3.5	3.7	8.3	7.8	16.8					
HNB2.5-4	4.3								
HNB2.5-5	5.3								
HNB2.5-6	6.4	12.0	11.0	21.8	6.0	5.6	3.4	12-10A.W.G. 4-6mm ²	
HNB5.5-3.5	3.7	7.2	6.1	15.7					
HNB5.5-4	4.3								
HNB5.5-5	5.3								9.5
HNB5.5-6	6.4	12.0	10.3	22.5					8.5
HNB5.5-8	8.4	15.0	13.5	27.0					
HNB 8-8	8.4	15.0	13.8	29.5					

Flange Spade Vinyl-Insulated Terminal

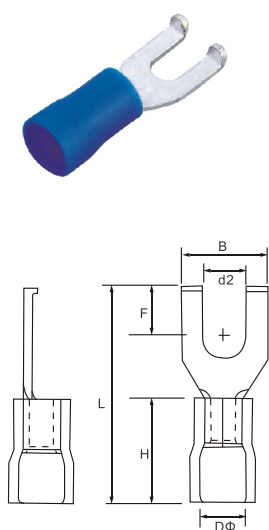

ITEM NO.	USA SCREW	d2Φ (mm)	Dimension(mm)					Color	Explanation
			B	L	F	H	DΦ		
FSV 1.25-3.5	#6	3.7	7.5	19.0	5.1	10.0	4.3	Red	Cable size: 0.5-1.5mm ² (A.W.G22~16) Max current: I _{max} =27A Material: Copper Plating: Tin
FSV 1.25-4	#8	4.3	7.5	19.0	5.1				
FSV 1.25-5	#10	5.3	7.5	19.0	5.1				
FSV 2-3.5	#6	3.7	7.5	19.0	5.2	10.0	4.9	Blue	Cable size: 0.5-1.5mm ² (A.W.G22~16) Max current: I _{max} =27A Material: Copper Plating: Tin
FSV 2-4	#8	4.3	7.5	19.0	5.2				
FSV 2-5	#10	5.3	7.5	19.0	5.2				
FSV 5.5-3.5	#6	3.7	8.5	25.5	7.5	13.0	6.7	Yellow	Cable size: 0.5-1.5mm ² (A.W.G22~16) Max current: I _{max} =27A Material: Copper Plating: Tin
FSV 5.5-4	#8	4.3	8.5	25.5	7.5				
FSV 5.5-5	#10	5.3	8.5	25.5	7.5				

Lipped Blade Vinyl -Insulated Terminal

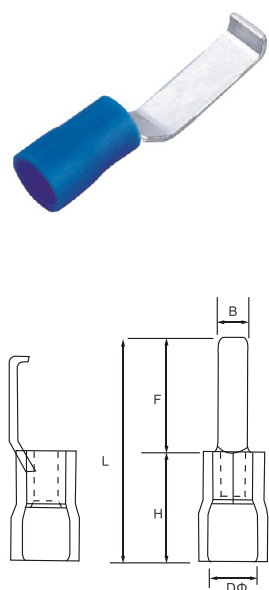

ITEM NO.	Dimension(mm)					Color	Explanation
	B	L	F	H	DΦ		
LBV 1.25-3	3.0	26.8	16.8	10.0	4.3	Red	Cable size: 0.5-1.5mm ² (A.W.G22~16) Max current: I _{max} =27A Material: Copper Plating: Tin
LBV 1.25-4.6	4.6	26.8	16.8				
LBV 2-3	3.0	26.8	16.8	10.0	4.9	Blue	Cable size: 0.5-1.5mm ² (A.W.G22~16) Max current: I _{max} =27A Material: Copper Plating: Tin
LBV 2-4.6	4.6	26.8	16.8				
LBV 5.5-3	3.0	29.3	16.8	13.0	6.7	Yellow	Cable size: 0.5-1.5mm ² (A.W.G22~16) Max current: I _{max} =27A Material: Copper Plating: Tin
LBV 5.5-4.6	4.6	29.3	16.8				

Long Full Insulating Middle Joint(Nylon)

1max=26-22 A.W.G:9A 26-16 A.W.G:19A
16-14 A.W.G:27A 12-10 A.W.G:48A

Max withstanding pressure:105℃ 600V Insulating Cover Material:Nylon

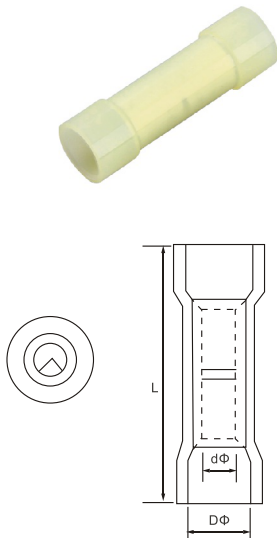

ITEM NO.	Dimension(mm)			Joint material	A.W.G (mm)	Color	Explanation
	L	DΦ	dΦ				
BNY1.25	27.3	3.2	1.7	Copper	22-16A.W.G 0.5-1.5mm ²	Red	Cable size: 0.5-1.5mm ² (A.W.G22~16) Max current: I _{max} =27A Material: Copper Plating:Tin
BNY2	27.3	3.8	2.3	Copper	16-14A.W.G 1.5-2.5mm ²	Blue	
BNY5.5	27.3	5.3	3.4	Copper	12-10A.W.G 4-6mm ²	Yellow	

Flag Female Insulating Joint(Nylon)

1max=26-22 A.W .G:9A 26-16 A.W.G:19A
16-14 A.W.G:27A 12-10 A.W.G:48A

Max withstanding pressure:105℃ 600V
Material:Brass Insulating
Cover Material:Nylon
Thickness:0.4mm



ITEM NO.	Connect Specification	Dimension(mm)				A.W.G (mm)	Color	Explanation
		W	F	L	dΦ			
FLDNY 1.25-250	0.8x6.35	6.6	7.6	16.0	17	22-18A.W.G 0.5-1.5mm ²	Red	Cable size: 0.5-1.5mm ² (A.W.G22~16) Max current: I _{max} =27A Material: Copper Plating: Tin
FLDNY 2-250	0.8x6.35	6.6	7.6	16.0	17	16-14A.W.G 1.5-2.5mm ²	Blue	
FLDNY 5.5-250	0.8x6.35	6.6	7.6	16.0	17	12-10A.W.G 4-6mm ²	Yellow	

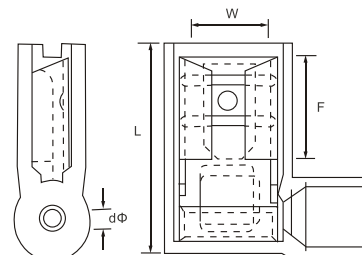

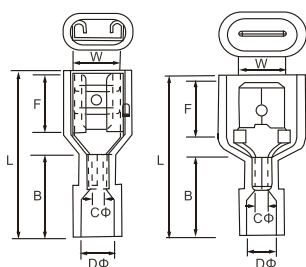

Male and Female Full-Insulating Joint(Nylon)

ITEM NO.	Connect Specification	Dimension(mm)								A.W.G (mm)	Color
		W	F	L	B	DΦ	CΦ	T	Fig		
FDFN 1.25-250	0.8x6.35	6.6	7.3	22.0	11.0	4.0	1.7	0.4	1	22-16 A.W.G 0.5-1.5 mm ²	Red
MDFN 1.25-250	0.8x6.35	6.35	7.7	23.0					2		
FDFN 2-250	0.8x6.35	6.6	7.3	22.0	11.0	4.5	2.3	0.4	1	16-14 A.W.G 1.5-2.5 mm ²	Blue
MDFN 2-250	0.8x6.35	6.35	7.7	24.0					2		
FDFN 5.5-250	0.8x6.35	6.6	7.3	24.0	13.0	6.3	3.4	0.4	1	12-10 A.W.G 4-6 mm ²	Yellow
MDFN 5.5-250	0.8x6.35	6.35	7.7	25.0					2		

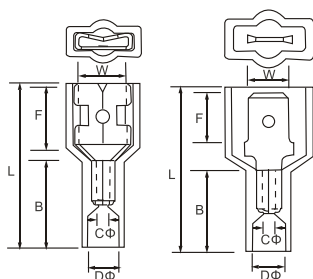

Male and Female Full-Insulating Joint(Nylon)

ITEM NO.	Connect Specification	Dimension(mm)								A.W.G (mm)	Color
		W	F	L	B	DΦ	CΦ	T	Fig		
FDFNY 1.25-250	0.8x6.35	6.6	7.3	22.0	12.0	4.0	1.7	0.45	1	22-16 A.W.G 0.5-1.5 mm ²	Red
MDFNY 1.25-250	0.8x6.35	6.35	7.7	23.0	11.0	4.0	1.7	0.8	2		
FDFNY 2-250	0.8x6.35	6.6	7.3	23.0	12.0	4.5	2.3	0.45	1	16-14 A.W.G 1.5-2.5 mm ²	Blue
MDFNY 2-250	0.8x6.35	6.35	7.7	24.0	11.0	4.5	2.3	0.8	2		
FDFNY 5.5-250	0.8x6.35	6.6	7.3	23.0	12.0	5.0	3.4	0.45	1	12-10 A.W.G 4-6 mm ²	Yellow
MDFNY 5.5-250	0.8x6.35	6.35	7.7	24.0	11.0	5.0	3.4	0.8	2		

PVC Insulated Terminal Sleeve

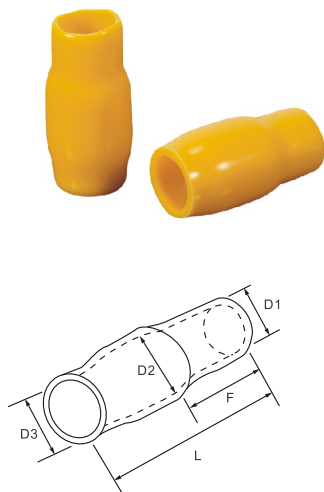

ITEM NO.	Dimension(mm)				
	D1	D2	D3	L	F
V1.25	2.8	3.3	3.1	13.0	7.0
V2	3.3	4.5	3.7	15.0	7.0
V3.5	4.2	5.7	4.1	20.0	8.0
V5.5	4.8	5.7	5.2	20.0	8.0
V8	6.2	7.2	6.2	20.0	9.0
V14	7.5	10.0	8.0	27.0	11.0
V22	10.5	12.0	9.5	30.0	15.0
V38	12.5	14.0	11.8	36.0	16.5
V60	15.0	16.8	13.5	39.0	19.0
V70	16.0	17.5	14.5	43.0	20.0
V80	17.0	19.0	16.0	47.0	22.0
V100	19.0	22.0	18.0	54.0	24.0
V125	21.0	24.0	20.0	57.0	25.0
V150	23.0	24.5	22.0	65.0	30.0
V200	27.0	32.0	24.0	65.0	30.0
V240	29.0	38.0	26.0	77.0	39.0
V325	29.0	38.0	29.0	77.0	40.0
V400	42.0	45.0	36.0	85.0	41.0
V500	46.0	48.0	40.0	88.0	42.0
V630	52.0	54.0	44.0	92.0	47.0

Open Barrel Terminals (Female&Male)



ITEM NO.	Metal	Wire range	Dimension(mm)			Thickness
			D	W	E	
Y 3-2.5	Brass	0.5-2.5	3.2			0.6
DJ 431-3A		0.5-0.8	3.5	9.0	17.0	0.5
DJ 431-5A		0.5-0.8	5.2	10.0	17.0	0.5
DJ 431-6A		0.5-0.8	6.2	12.0	17.0	0.5
DJ 431-8B		1.0-1.5	8.2	15.0	17.0	0.8
DJ 431-10B		1.0-1.5	10.5	19.0	19.0	0.8

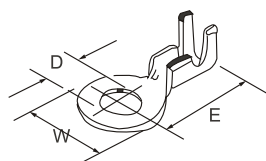
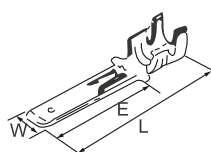
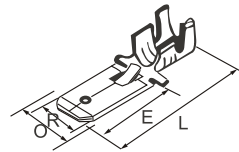

Fig	ITEM NO.	Metal	Wire range	Dimension(mm)				Thickness
				D	W	L	E	
A	DJ611-2.8x0.5B	Brass	1.0-1.5		2.8	21.0	12.0	0.5
B	DJ611-6.3A		0.5-0.8	7.9	6.3	25.0	13.8	0.4
B	DJ611-6.3B		1.0-1.5	7.9	6.3	25.0	13.8	0.4
B	DJ612-6.3C		2.0-2.5	7.9	6.3	25.0	13.8	0.4
C	DJ617-6.3B		1.0-1.5		6.3	19.2		0.4



A



B

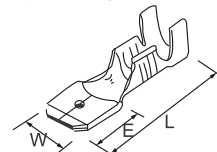

C

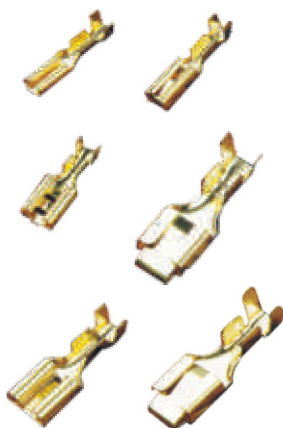
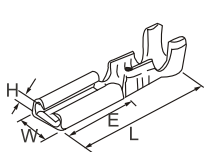
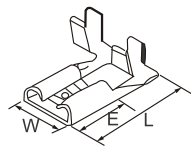

Fig	ITEM NO.	Metal	Wire range	Dimension(mm)			Thickness
				W	L	E	
A	DJ621-E2.8x0.5B	Brass	1.0-1.5	4.1	16.0	6.6	0.3
A	DJ621-D2.8x0.5A		0.5-0.8	3.7	15.1	6.3	0.25
A	DJ621-E2.8x0.5A		0.5-0.8	6.0	13.8	<div></div>	0.3
B	DJ625-4.8x0.8A		0.5-0.8	6.4	12.0		6.2
C	DJ621-5A		0.5-0.8	5.2	17	5.5	0.3
C	DJ611-5B		1.0-1.5	5.2	17	5.5	0.3
D	DJ622-A6.3B		1.0-1.5	7.7	18.5	7.5	0.3
E	DJ622-D6.3A		1.0-1.5	7.7	17.5	7.5	0.4



A



B

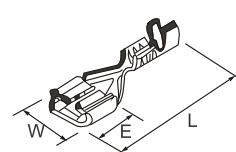

C

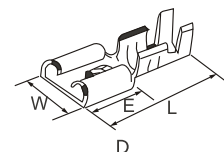

D

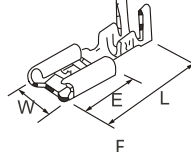

E

Open Barrel Terminals (Female&Male)



Fig	ITEM NO.	Metal	Wire range	Dimension(mm)					Thickness
				D	H	W	L	E	
A	DJ211-3.5B	Brass	1.0-1.5			3.5	15.0		0.5
A	DJ211-4B		1.0-1.5			4.0	16.0		0.5
B	DJ221-2.3B		1.0-1.5			3.9	19.0	17.4	0.3
B	DJ221-3.5B		1.0-1.5			3.3	17.6	6.5	0.3
B	DJ221-4B		1.0-1.5			3.8	17.6	6.5	0.4

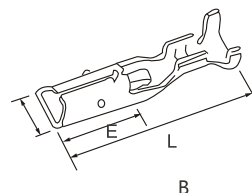
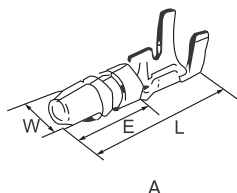

Terminals Blocks

Terminals Blocks H,Y(W),V(F) Type Material:made from PA,PE or PP.

Application

H.FW. Series terminal connectors are used in the circuits of AC.50Hz or 60Hz voltage up to 660V or DC.Volitage 150A,for conn-ecting the round copper conductors.

Specification

ITEM NO.	L	A	H	M	B	mm ²	VOLT	AMP	Packing
DL-3A	93	16	16	6	8	4	400V	3A	10PCS
DL-6A	115	15.7	15.7	6.5	9.5	6	400V	6A	
DL-10A	126	20.2	20.2	8.4	10.5	10	400V	10A	
DL-16A	139	23	23	10.3	12	12	400V	16A	
DL-20A	155	25	25	11.5	13.5	14	400V	20A	
DL-30A	171	26	26	12	14.5	16	400V	30A	
DL-60A	192	30	30	13.5	16.5	25	400V	60A	
DL-80A	205	33	33	15	17	35	400V	80A	
DL-100A	250	46	46	22	21	40	400V	100A	

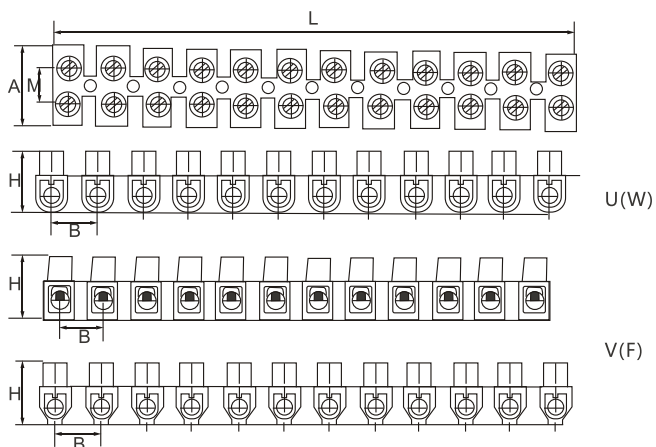
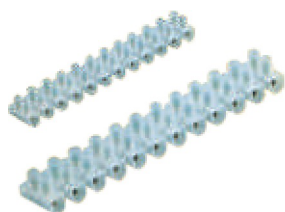
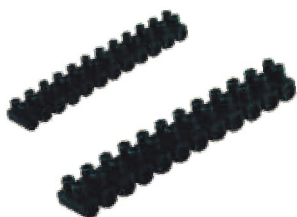
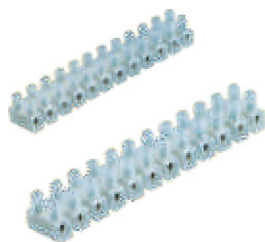

Circle Cable Clips

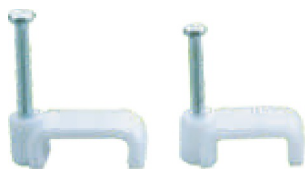

Material:PP,Steel nail

How to use:Put the cable under the clip and hammer the nail into the wall to secure the cable.

Application:Securinll of Gables for general indoor wiring

	H (mm)	R (mm)	Nail (mm)	Packing/bag
4mm	5.3	4	1.7x15	100PCS
5mm	6.5	5	1.7x15	
6mm	8.1	6	1.7x15	
7mm	8.7	7	1.8x19	
8mm	9.6	8	1.9x21	
9mm	10.7	9	2.0x22	
10mm	11.7	10	2.05x25	
12mm	12.8	12	2.05x27	
14mm	14.9	14	2.4x32	
16mm	16.9	16	2.5x35	
18mm	20.8	18	2.8x37	
20mm	23.6	20	2.8x42	
22mm	25.0	22	2.8x48	
25mm	27.7	25	3.2x48	
30mm	33.1	30	3.2x53	
35mm	36.6	35	3.2x58	
40mm	45.2	40	3.4x60	

Square Cable Clips

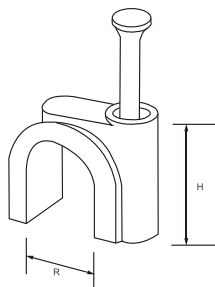
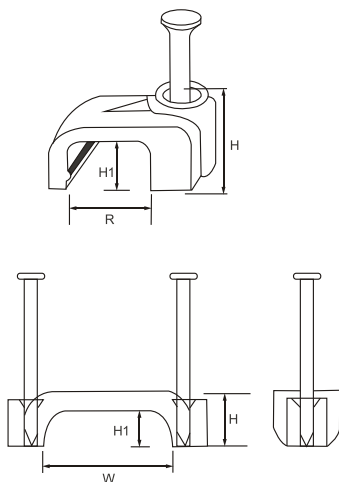

Material:PP,Steel nail

How to use:Put the cable under the clip and hammer the nail into the wall to secure the cable.

Application:Securinll of Gables for general indoor wiring

	H (mm)	IN-DIAMETER		Nail MM	Packing/bag
		H1 (mm)	R (mm)		
4mm	6.0	3.8	4	1.7x15	100PCS
5mm	6.0	3.8	5	1.7x15	
6mm	6.5	4.1	6	1.7x16	
7mm	7.0	4.7	7	1.9x18	
8mm	7.5	5.0	8	2.05x20	
9mm	8.2	5.4	9	2.05x23	
10mm	8.6	5.7	10	2.3x23	
12mm	9.0	6.1	12	2.3x23	
14mm	11.2	6.5	14	2.4x30	

Double Nail Flat Cable Clips

ITEM NO.	W	H	H1	SUITABLE WIRES	NAILS	Packing/bag
DL-13	12.5	8	8	#14/2 14/3 12/2	1.86X31	100PCS
DL-19	18.7	8	8	#12/3 10/23 10/3	1.86X31	

 The product data referred to in the company shall be subject to material object. Subject to change without notice.
The company has the final right to interpret.

 Green paper printing.

WESTLEC

WENZHOU ETEK IMPORT & EXPORT CO.,LTD.

No.288 Wei 17th Road, Economic Development Zone, Yueqingcity, Zhejiang china

Tel: 0086-577-62718777 0086-577-62780116

Email: sales@westlec.com

Web: westlec.com